



THE
SANTORINI

Inspired by the Greek islands. Created by artisans.

Emerging straight out of a Greek island vista, statuesque towers accentuate the horizon – serene sculptures transcending time and place. Simplicity and elegance is manifest in precise lines, pure glass, and pristine white accented by the blue of the sea. A statement of the contemporary, with distinct character that redefines the position.

The architecture is crafted by AGA Architects, an experienced and evolving architectural practice with a portfolio of works including J Gateway, Sea Horizon, Terrasse, and the award-winning The Peak @ Balmeg and Hillcrest Villa.



The Greek island landscape unfolds, unveiling a domain simultaneously expansive and confidently minimalist. Enchanting pocket gardens and lawns intersperse with soothing water features and resplendent pools. Explore a tapestry of themed enclaves eliciting discovery and delight – in communion with a canvas of lush yet contemporary green.

The landscape is crafted by ONG&ONG Landscape, a premier design practice with unparalleled reputation in landscape design, and projects in 18 countries spread over three continents.



Clear skies. Blue waters. Sun-kissed lands.
It's the Mediterranean lifestyle.
It's about enjoying life to the fullest.
And it's right here at The Santorini.

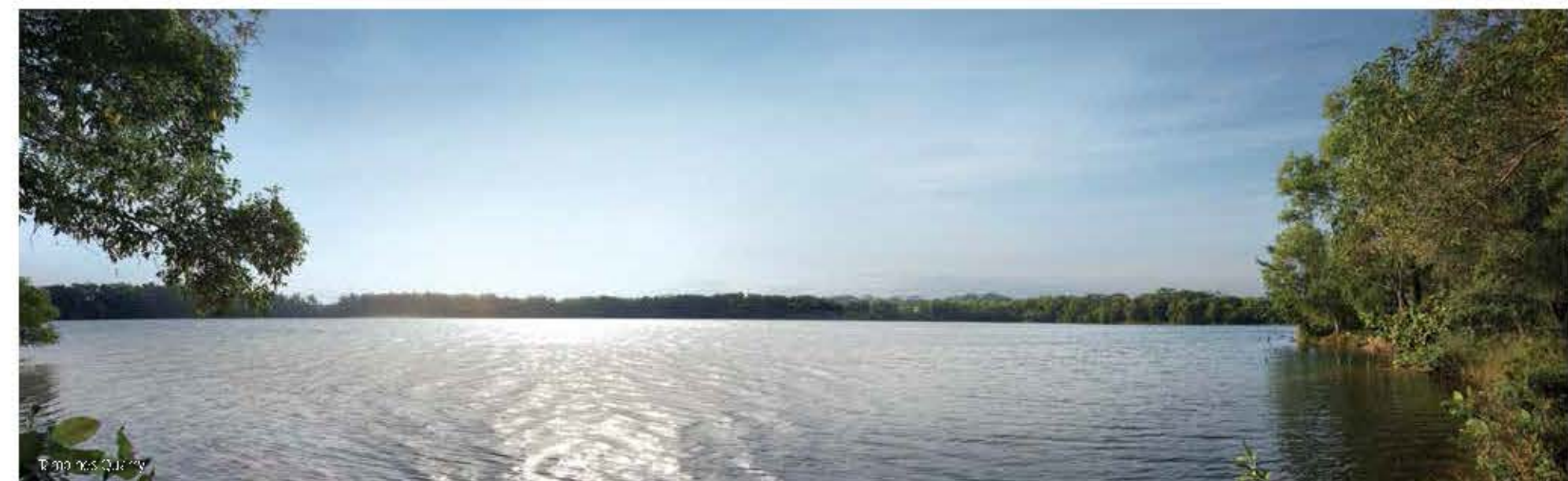

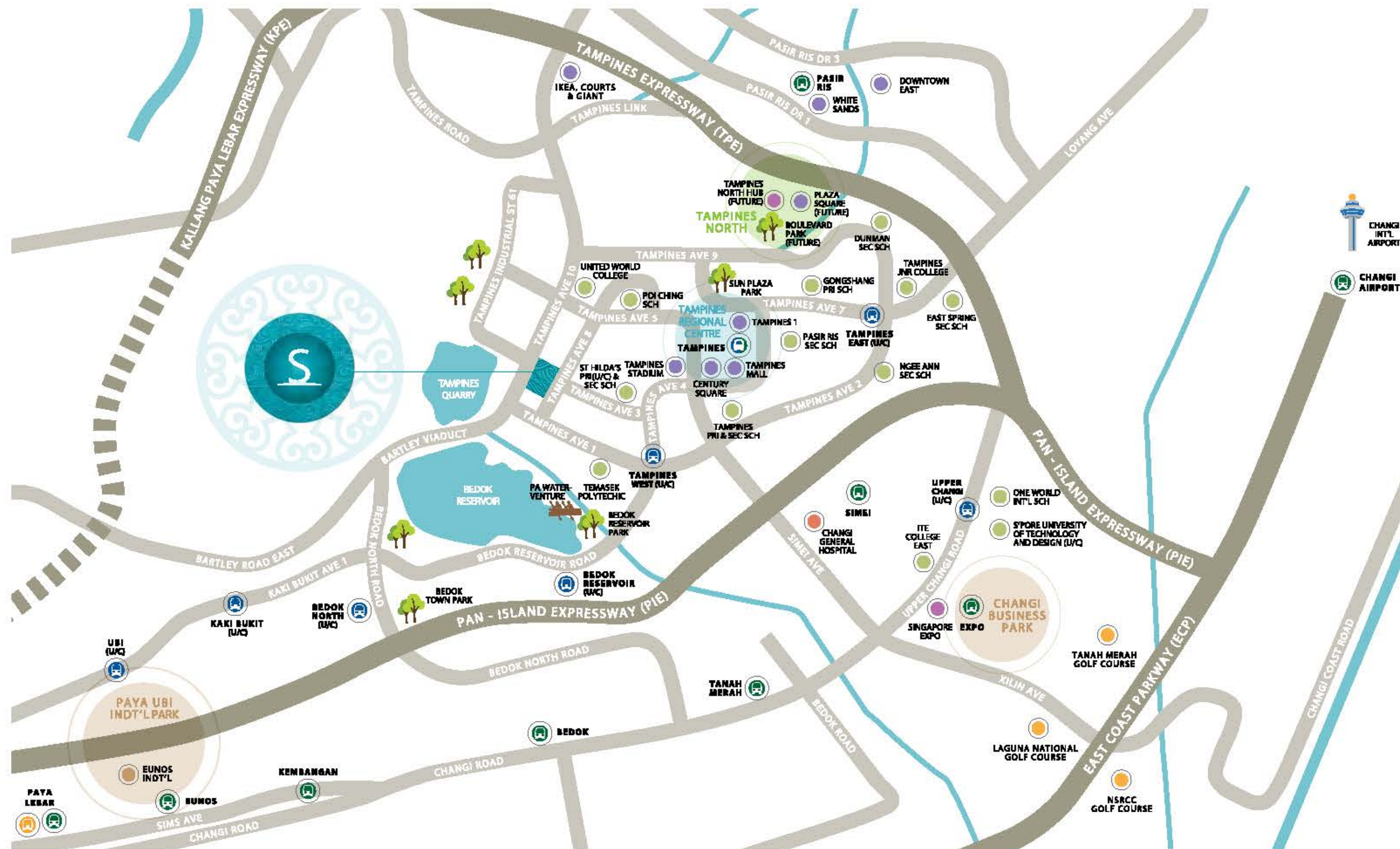

The centre of attraction,
connected to everything.

Ensnared within a central spot between two scenic water bodies, The Santorini connects you with the tranquil beauty of Bedok Reservoir and Tampines Quarry Park. Furthermore, it connects you to major arterial roads and expressways such as Tampines Expressway and the Pan Island Expressway. The new Bartley Viaduct provides direct access to Bartley Road, Braddell Road and Lornie Road, while the nearby Tampines MRT Station and bus interchange ushers you swiftly to all parts of the island.

Revel in a natural glow at Bedok Reservoir Park with outdoor activities like kayaking, wakeboarding, or simply stroll serenely. Let your eyes sparkle at Tampines Mall, Tampines One and Century Square with a scintillating spread of shopping and dining highlights. Your little jewels will positively shine at St Hilda's Primary School, United World College, Temasek Polytechnic or Singapore University of Technology and Design (U/TC).





Your neighbourhood shall blossom into the green hub of Tampines.

Tampines North (Future) is all set to blossom with new parks, and a seamless pedestrian and cycling network. A major green park, Quarry Park, features a thematic quarry pond inspired by the sand quarrying history of Tampines. Yet another major green park, Boulevard Park, will be lined with seasonal flowering trees, and flourishing with community spaces and convenient facilities like childcare centres.



Welcome to the world of the Greek islands.

Sail into The Santorini, and you'll find that your course is set for serenity. Discover a landscape more akin to a seascape, where Santorini Blue washes over an island of tranquillity. The Aegean Arrival welcomes you with fanfare, where a water wall cascades rhythmically onto characteristic Greek boulders. Make a splash in the lap pool, catch the rays on the lounge deck, or simply chill out at the clubhouse. You can also indulge in the wave gym and spa beds, or entertain alfresco at the dining and multipurpose pavilions floating over a reflective pool.

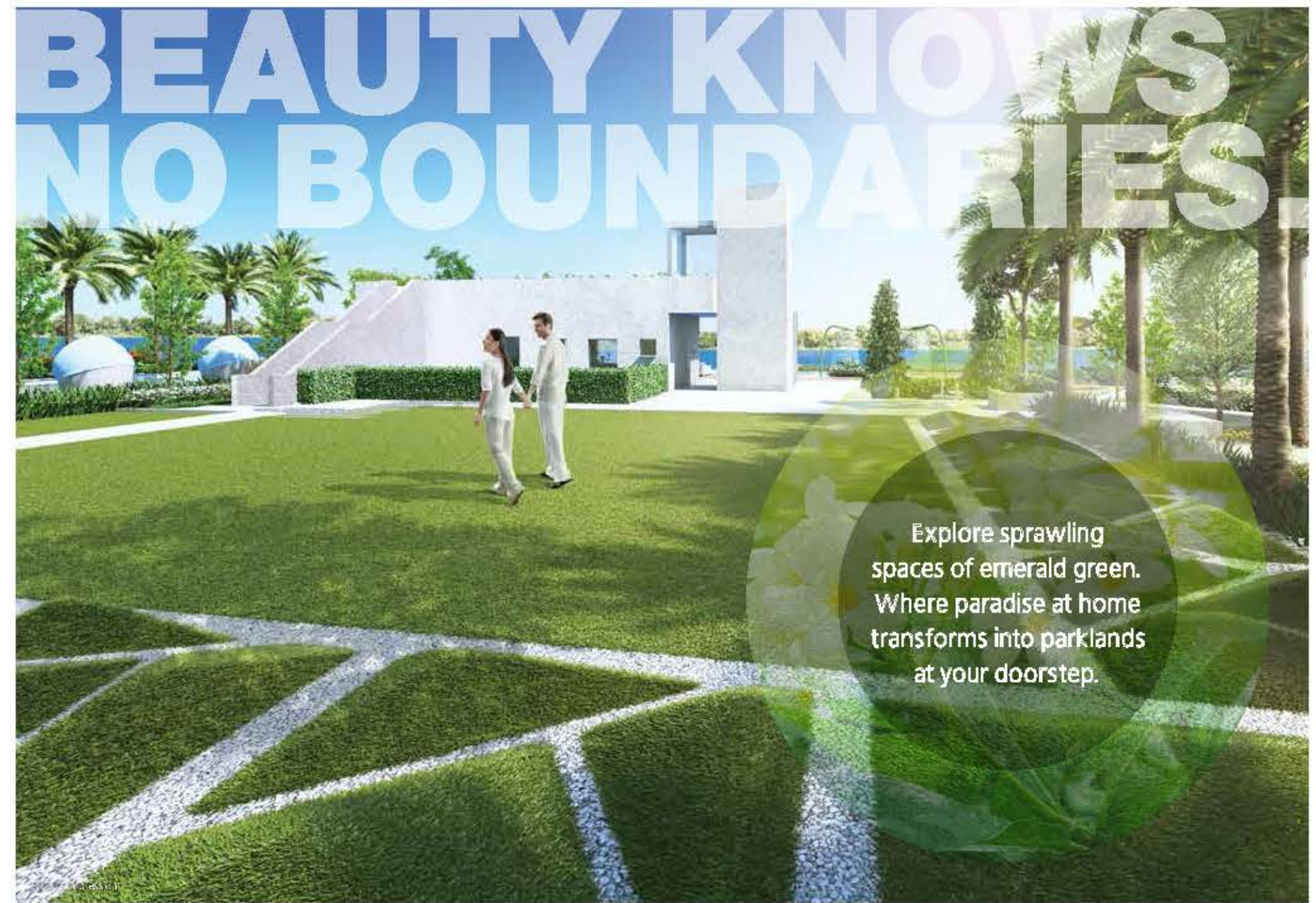
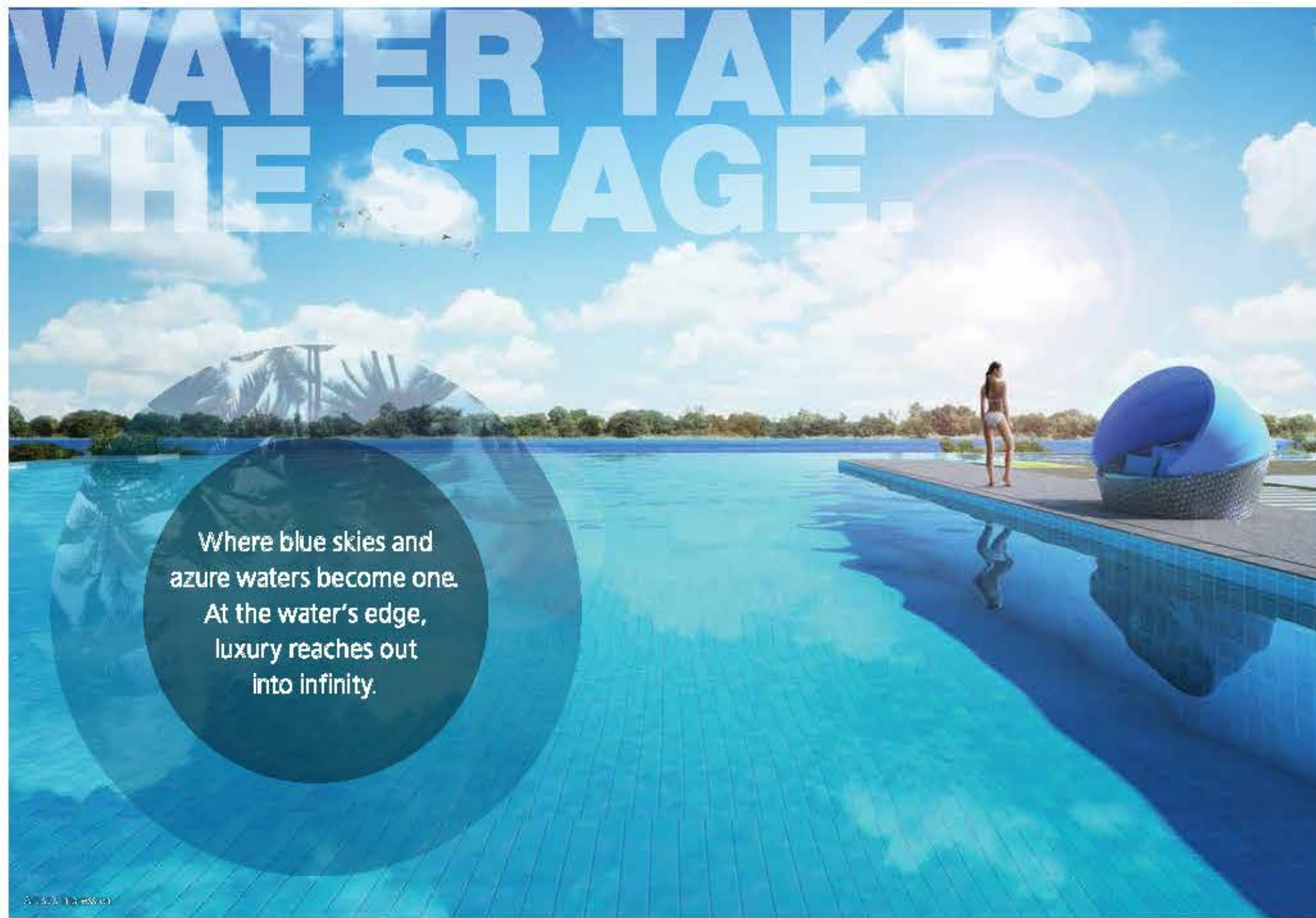

EXPAND YOUR WORLD.

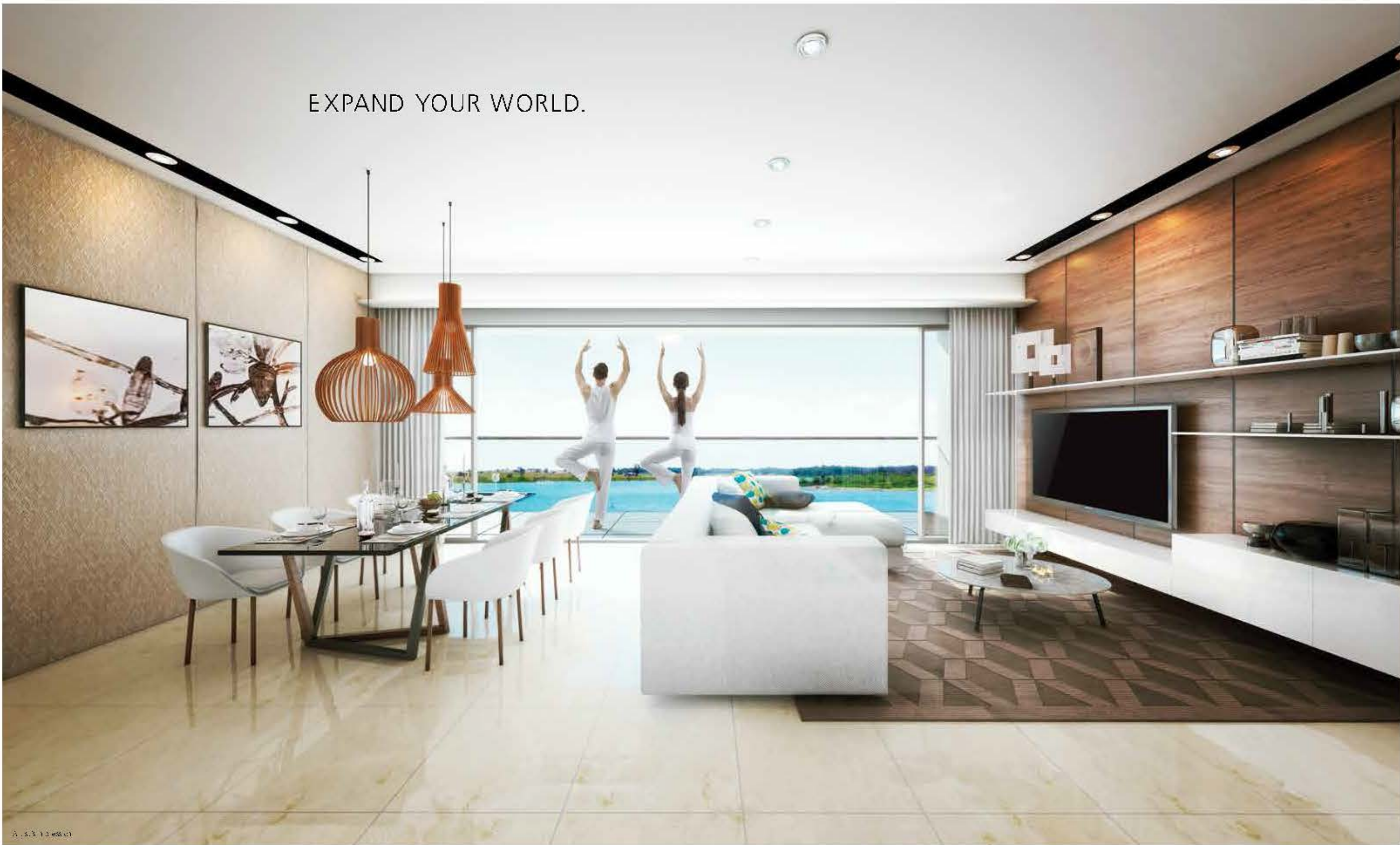

Flexible and efficient spaces thoughtfully designed into the apartment layouts.



Top-of-the-line household appliances at your service.



Outstanding bedroom finishings featuring the highest quality materials.



A selection of elegant bathroom fittings and finishings enhance the bathroom.



SITEPLAN

- 1 Aegean Arrival
- 2 Lap Pool
- 3 Kid's Pool
- 4 Lounge Deck
- 5 Aegean Splashes
- 6 Changing Rooms
- 7 Clubhouse Gymnasium
- 8 Drift-Away Hammocks
- 9 Grand Lawn
- 10 25m Lap Pool & Aqua Gym
- 11 Reflective Pool
- 12 The Gallery
- 13 Tennis Court
- 14 Alfresco BBQ Plaza
- 15 Kiddie Playground
- 16 Fitness Zone
- 17 Sunken Pavilion
- 18 Verdure Berms



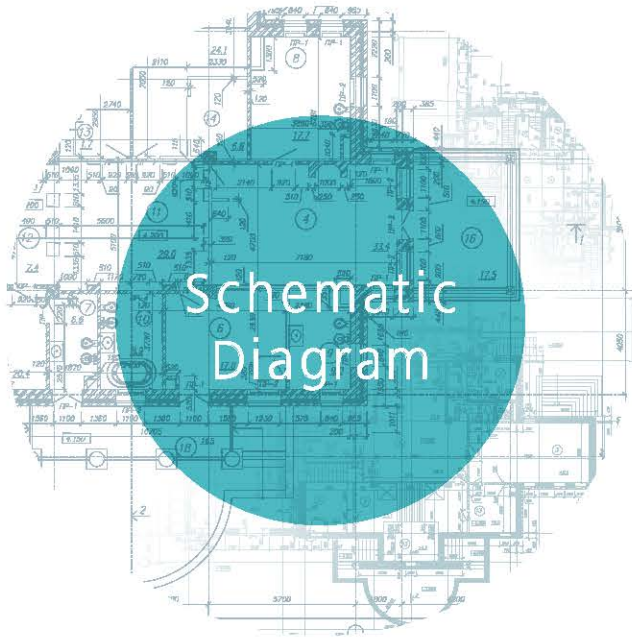

21 TAMPINES STREET 86

UNIT FLOOR	06	05	04		03	02	01
15	A2b	A3	A2b		A2b	A3	Communal Roof Garden
14	A2	A3b	A2		A2	A3b	B1
13	A2b	A3	A2b		A2b	A3	B1b
12	A2a	A3b	A2a		A2a	A3b	B1a
11	A2	A3a	A2		A2	A3a	B1
10	A2b	A3	A2b		A2b	A3	B1b
9	A2a	A3b	A2a		A2a	A3b	B1a
8	A2	A3a	A2		A2	A3a	B1
7	A2b	A3	A2b		A2b	A3	B1b
6	A2a	A3b	A2a		A2a	A3b	B1a
5	A2	A3a	A2		A2	A3a	B1
4	A2b	A3	A2b		A2b	A3	B1b
3	A2a	A3b	A2a		A2a	A3b	B1a
2	A2	A3a	A2		A2	A3a	B1
1	A2(Pa)	A3(Pa)	A2(Pa)		A2(Pa)	A3(Pa)	B1(Pa)

29 TAMPINES STREET 86

UNIT FLOOR	27	26
15	PH4 (#15-27)	Communal Roof Garden
14	C5c-DK	E1b
13	C5-DK	E1b
12	C5c-DK	E1a
11	C5a-DK	E1
10	C5-DK	E1b
9	C5c-DK	E1a
8	C5a-DK	E1
7	C5-DK	E1b
6	C5c-DK	E1a
5	C5a-DK	E1
4	C5-DK	E1b
3	C5c-DK	E1a
2	C5a-DK	E1
1	GD1-DK	E1(P)

UNIT FLOOR	29	28
15	PH2 (#15-28)	
14	C1b	C3c
13	C1	C3c
12	C1b	C3a
11	C1a	C3
10	C1	C3c
9	C1b	C3a
8	C1a	C3
7	C1	C3c
6	C1b	C3a
5	C1a	C3
4	C1	C3c
3	C1b	C3a
2	C1a	C3
1	C1(Pa)	C3(Pa)

31 TAMPINES STREET 86

UNIT FLOOR	31	30
15	B4b	
14	B4b	B4
13	B4	B4b
12	B4b	B4a
11	B4a	B4
10	B4	B4b
9	B4b	B4a
8	B4a	B4
7	B4	B4b
6	B4b	B4a
5	B4a	B4
4	B4	B4b
3	B4b	B4a
2	B4a	B4
1		

UNIT FLOOR	33	32
15	B2b	B5b-DK
14	B2b	B5a-DK
13	B2	B5-DK
12	B2b	B5b-DK
11	B2a	B5a-DK
10	B2	B5-DK
9	B2b	B5b-DK
8	B2a	B5a-DK
7	B2	B5-DK
6	B2b	B5b-DK
5	B2a	B5a-DK
4	B2	B5-DK
3	B2b	B5b-DK
2	B2a	B5a-DK
1	B2(P)	B5-DK(P)

21 TAMPINES STREET 86

UNIT FLOOR	13	12	11	10	09	08	07
15	B1b	A1	A1	A2	A2b	A4	A2
14	B1	A1	A1	A2b	A2	A4b	A2b
13	B1b	A1	A1	A2	A2b	A4	A2
12	B1a	A1	A1	A2b	A2a	A4b	A2b
11	B1	A1	A1	A2a	A2	A4a	A2a
10	B1b	A1	A1	A2	A2b	A4	A2
9	B1a	A1	A1	A2b	A2a	A4b	A2b
8	B1	A1	A1	A2a	A2	A4a	A2a
7	B1b	A1	A1	A2	A2b	A4	A2
6	B1a	A1	A1	A2b	A2a	A4b	A2b
5	B1	A1	A1	A2a	A2	A4a	A2a
4	B1b	A1	A1	A2	A2b	A4	A2
3	B1a	A1	A1	A2b	A2a	A4b	A2b
2	B1	A1	A1	A2a	A2	A4a	A2a
1	B1(P)	A1(P)	A1(P)	A2(P)	A2(P)	A4(P)	A2(P)

23 TAMPINES STREET 86

UNIT FLOOR	17	16
15	Communal Roof Garden	PH6 (#15-16)
14	C3c	C3c
13	C3c	C3
12	C3b	C3c
11	C3	C3a
10	C3c	C3
9	C3b	C3c
8	C3	C3a
7	C3c	C3
6	C3b	C3c
5	C3	C3a
4	C3c	C3
3	C3b	C3c
2	C3	C3a
1	C3(P)	C3(P)

UNIT FLOOR	15	14
15	B5b-DK	
14	B5b-DK	D3
13	B5-DK	D3c
12	B5b-DK	D3b
11	B5a-DK	D3
10	B5-DK	D3c
9	B5b-DK	D3b
8	B5a-DK	D3
7	B5-DK	D3c
6	B5b-DK	D3b
5	B5a-DK	D3
4	B5-DK	D3c
3	B5b-DK	D3b
2	B5a-DK	D3
1	B5-DK(P)	GD1-DK

33 TAMPINES STREET 86

UNIT FLOOR	35	34
15		C4b-DK
14	B3b	C4-DK
13	B3	C4b-DK
12	B3b	C4a-DK
11	B3a	C4-DK
10	B3	C4b-DK
9	B3b	C4a-DK
8	B3a	C4-DK
7	B3	C4b-DK
6	B3b	C4a-DK
5	B3a	C4-DK
4	B3	C4b-DK
3	B3b	C4a-DK
2	B3a	C4-DK
1	B3(Pa)	C4-DK(Pa)

UNIT FLOOR	37	36
15	PH1 (#15-37)	
14	C3c	B2b
13	C3b	B2
12	C3	B2b
11	C3c	B2a
10	C3b	B2
9	C3	B2b
8	C3c	B2a
7	C3b	B2
6	C3	B2b
5	C3c	B2a
4	C3b	B2
3	C3	B2b
2	C3c	B2a
1	C3(P)	B2(P)

35 TAMPINES STREET 86

UNIT FLOOR	39	38
14	B4b	B4b
13	B4b	B4
12	B4a	B4b
11	B4	B4a
10	B4b	B4
9	B4a	B4b
8	B4	B4a
7	B4b	B4
6	B4a	B4b
5	B4	B4a
4	B4b	B4
3	B4a	B4b
2	B4	B4a
1	B4(P)	B4(P)

UNIT FLOOR	41	40
14	C2b	C2b
13	C2b	C2
12	C2a	C2b
11	C2	C2a
10	C2b	C2
9	C2a	C2b
8	C2	C2a
7	C2b	C2
6	C2a	C2b
5	C2	C2a
4	C2b	C2
3	C2a	C2b
2	C2	C2a
1	C2(P)	C2(P)

25 TAMPINES STREET 86

UNIT FLOOR	21	20
15	Communal Roof Garden	PH5 (#15-20)
14	D2b-DK	D1
13	D2-DK	D1b
12	D2b-DK	D1a
11	D2a-DK	D1
10	D2-DK	D1b
9	D2b-DK	D1a
8	D2a-DK	D1
7	D2-DK	D1b
6	D2b-DK	D1a
5	D2a-DK	D1
4	D2-DK	D1b
3	D2b-DK	D1a
2	D2a-DK	D1
1	GD2-DK	D1(P)

UNIT FLOOR	19	18
15	B5b-DK	
14	B5b-DK	D3
13	B5-DK	D3c
12	B5b-DK	D3b
11	B5a-DK	D3
10	B5-DK	D3c
9	B5b-DK	D3b
8	B5a-DK	D3
7	B5-DK	D3c
6	B5b-DK	D3b
5	B5a-DK	D3
4	B5-DK	D3c
3	B5b-DK	D3b
2	B5a-DK	D3
1	B5-DK(Pa)	GD1-DK

27 TAMPINES STREET 86

UNIT FLOOR	23	22
15	PH3 (#15-23)	Communal Roof Garden
14	D3c	D3c
13	D3c	D3
12	D3b	D3c
11	D3	D3a
10	D3c	D3
9	D3b	D3c
8	D3	D3a
7	D3c	D3
6	D3b	D3c
5	D3	D3a
4	D3c	D3
3	D3b	D3c
2	D3	D3a
1	GD1-DK	GD1-DK

UNIT FLOOR	25	24
15	PH2 (#15-24)	
14	C3c	C1b
13	C3c	C1
12	C3a	C1b
11	C3	C1a
10	C3c	C1
9	C3a	C1b
8	C3	C1a
7	C3c	C1
6	C3a	C1b
5	C3	C1a
4	C3c	C1
3	C3a	C1b
2	C3	C1a
1	C3(Pa)	C1(Pa)

LEGEND

- 1-BEDROOM
- 5-BEDROOM

- 2-BEDROOM &
2-BEDROOM DUAL KEY
- 3- & 4-BEDROOM
GARDEN DUPLEX

- 3-BEDROOM &
3-BEDROOM DUAL KEY
- PENTHOUSE

- 4-BEDROOM

1 BR
SUITE

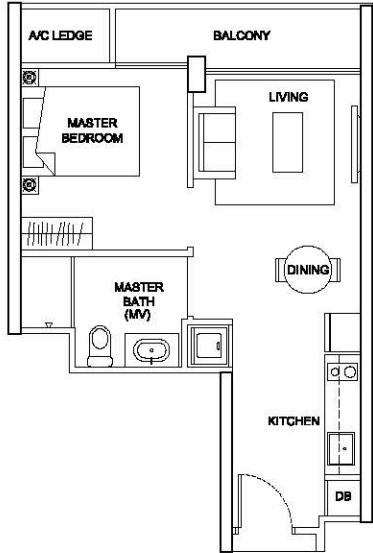

TYPE A1
43 sqm

#02-11, #03-11, #04-11, #05-11,
#06-11, #07-11, #08-11, #09-11,
#10-11, #11-11, #12-11, #13-11,
#14-11, #15-11 (Mirror Units)

#02-12, #03-12, #04-12, #05-12,
#06-12, #07-12, #08-12, #09-12,
#10-12, #11-12, #12-12, #13-12,
#14-12, #15-12

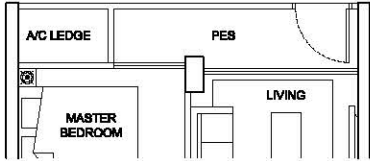

TYPE A1(P)
43 sqm

#01-11 (Mirror Unit)
#01-12

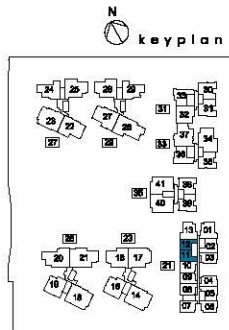

NOTE: #15-11, #15-12 - HIGH CEILING UNITS
Area Includes A/C ledge, balcony, PES, roof terrace and void (where applicable). Orientation and fittings will differ depending on the unit you are purchasing (please refer to key plan). All plans are not to scale and subject to changes as may be required by relevant authorities.
All appliances and furniture shown in the plan are for illustration purpose only and not representation of fact.
All floor areas are estimated and subjected to final survey.

1 BR
SUITE

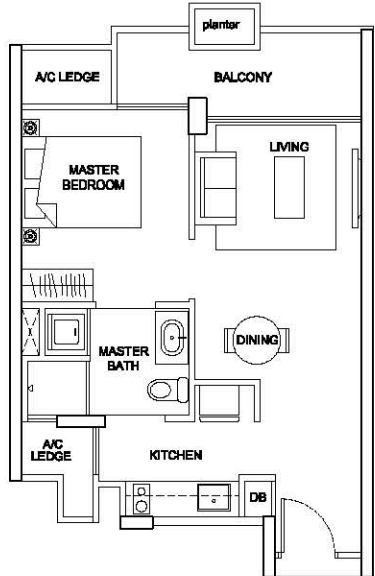

TYPE A2
49 sqm

#02-04, #05-04, #08-04, #11-04, #14-04,
#04-07, #07-07, #10-07, #13-07, #15-07,
#04-10, #07-10, #10-10, #13-10, #15-10

#02-03, #05-03, #08-03, #11-03, #14-03,
#02-08, #05-08, #08-08, #11-08, #14-08,
#02-09, #05-09, #08-09, #11-09, #14-09 (Mirror Units)

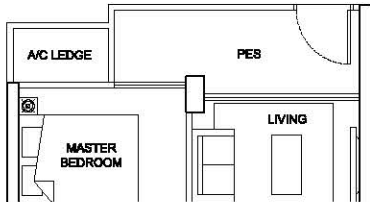

TYPE A2(P)
49 sqm

#01-07, #01-10
#01-09 (Mirror Unit)

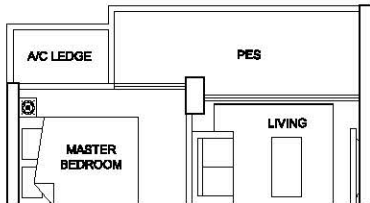

TYPE A2(Pa)
49 sqm

#01-04
#01-03, #01-06 (Mirror Units)

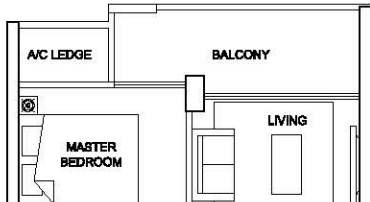

TYPE A2a
49 sqm

#03-04, #08-04, #09-04, #12-04,
#02-07, #05-07, #08-07, #11-07,
#02-10, #05-10, #08-10, #11-10,

#03-03, #08-03, #09-03, #12-03,
#03-06, #06-06, #09-06, #12-06,
#03-09, #06-09, #09-09, #12-09 (Mirror Units)

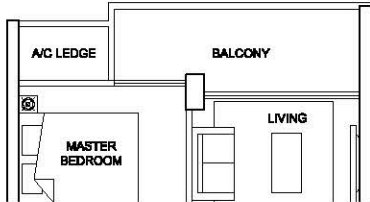

TYPE A2b
49 sqm

#04-04, #07-04, #10-04, #13-04, #15-04,
#03-07, #06-07, #09-07, #12-07, #14-07,
#03-10, #06-10, #09-10, #12-10, #14-10,

#04-03, #07-03, #10-03, #13-03, #15-03,
#04-06, #07-06, #10-06, #13-06, #15-06,
#04-09, #07-09, #10-09, #13-09, #15-09 (Mirror Units)

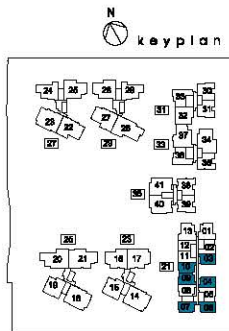

NOTE: #15-03, #15-04, #15-06, #15-07, #15-08, #15-10 - HIGH CEILING UNITS
Area Includes A/C ledge, balcony, PES, roof terrace and void (where applicable). Orientation and fittings will differ depending on the unit you are purchasing (please refer to key plan). All plans are not to scale and subject to changes as may be required by relevant authorities.
All appliances and furniture shown in the plan are for illustration purpose only and not representation of fact.
All floor areas are estimated and subjected to final survey.

1 BR
SUITE

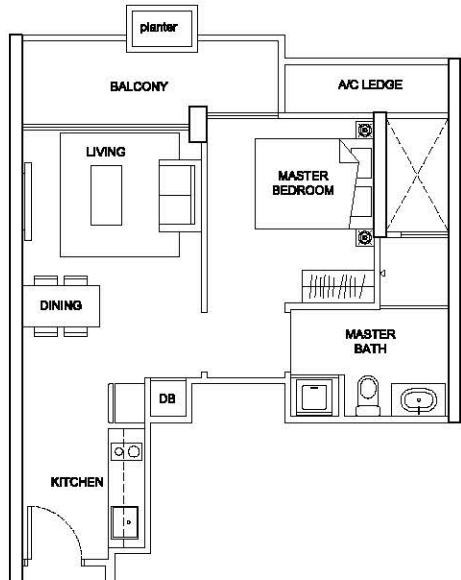

TYPE A3
49 sqm

#04-05, #07-05, #10-05, #13-05, #15-05

#04-02, #07-02, #10-02, #13-02, #15-02 (Mirror Units)

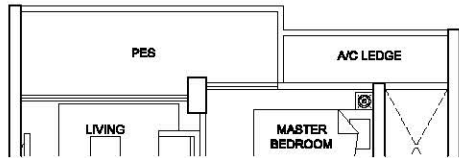

TYPE A3(Pa)
49 sqm

#01-05
#01-02 (Mirror Unit)

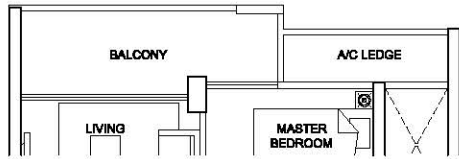

TYPE A3a
49 sqm

#02-05, #05-05, #08-05, #11-05

#02-02, #05-02, #08-02, #11-02 (Mirror Units)

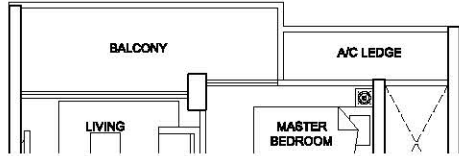

TYPE A3b
49 sqm

#03-05, #06-05, #09-05, #12-05, #14-05

#03-02, #06-02, #09-02, #12-02, #14-02 (Mirror Units)

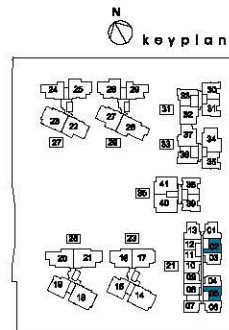

NOTE: #15-02, #15-06 - HIGH CEILING UNITS
Area Includes A/C ledge, balcony, PES, roof terrace and void (where applicable). Orientation and fittings will differ depending on the unit you are purchasing (please refer to key plan). All plans are not to scale and subject to changes as may be required by relevant authorities.
All appliances and furniture shown in the plan are for illustration purpose only and not representation of fact.
All floor areas are estimated and subjected to final survey.

1 BR
SUITE

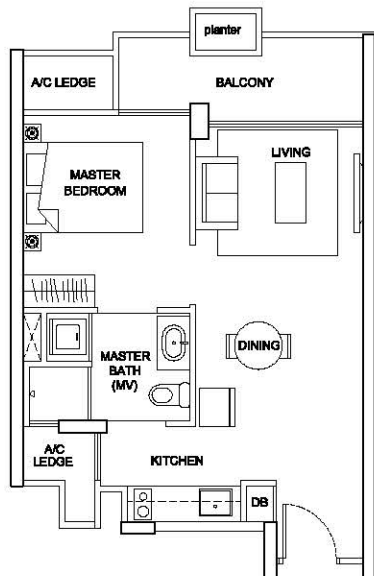

TYPE A4
49 sqm

#04-08, #07-08, #10-08, #13-08,
#15-08

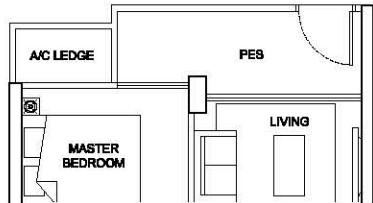

TYPE A4(P)
49 sqm

#01-08

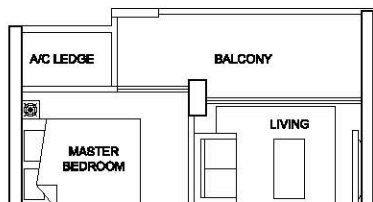

TYPE A4a
49 sqm

#02-08, #05-08, #08-08, #11-08

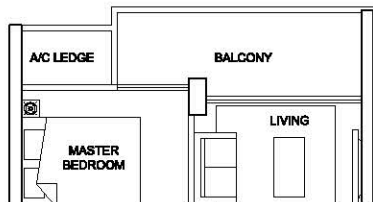

TYPE A4b
49 sqm

#03-08, #06-08, #09-08, #12-08,
#14-08

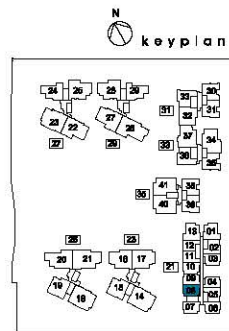

NOTE: #15-08 - HIGH CEILING UNIT
Area Includes A/C ledge, balcony, PES, roof terrace and void (where applicable). Orientation and fittings will differ depending on the unit you are purchasing (please refer to key plan). All plans are not to scale and subject to changes as may be required by relevant authorities.
All appliances and furniture shown in the plan are for illustration purpose only and not representation of fact.
All floor areas are estimated and subjected to final survey.

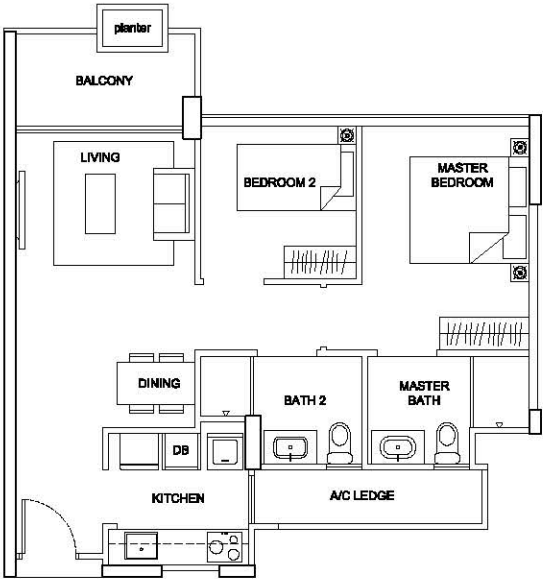

TYPE B1

68 sqm

#02-13, #05-13, #08-13, #11-13, #14-13

#02-01, #05-01, #08-01, #11-01, #14-01 (Mirror Units)

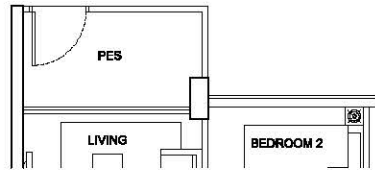

TYPE B1(P)

67 sqm

#01-13

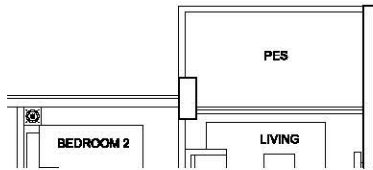

TYPE B1(Pa)

67 sqm

#01-01 (Mirror Unit)

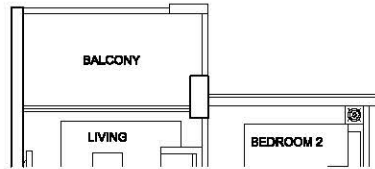

TYPE B1a

67 sqm

#03-13, #06-13, #09-13, #12-13

#03-01, #06-01, #09-01, #12-01 (Mirror Units)

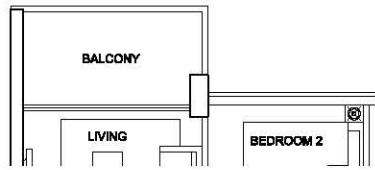

TYPE B1b

67 sqm

#04-13, #07-13, #10-13, #13-13, #15-13

#04-01, #07-01, #10-01, #13-01 (Mirror Units)

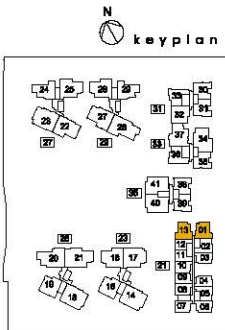

NOTE: #15-13 - HIGH CEILING UNIT

Area includes A/C ledge, balcony, PES, roof terrace and void (where applicable). Orientation and fittings will differ depending on the unit you are purchasing (please refer to key plan). All plans are not to scale and subject to changes as may be required by relevant authorities. All appliances and furniture shown in the plan are for illustration purpose only and not representation of fact. All floor areas are estimated and subjected to final survey.

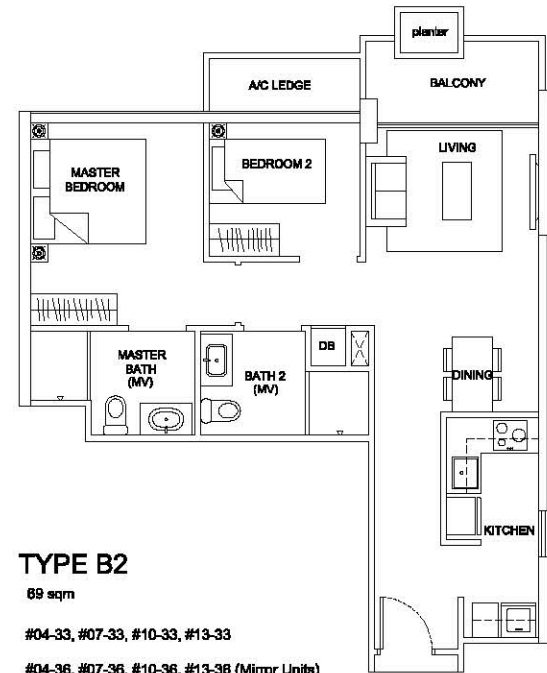

TYPE B2

69 sqm

#04-33, #07-33, #10-33, #13-33

#04-36, #07-36, #10-36, #13-36 (Mirror Units)

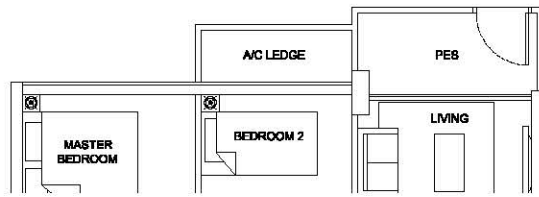

TYPE B2(P)

69 sqm

#01-33

#01-36 (Mirror Unit)

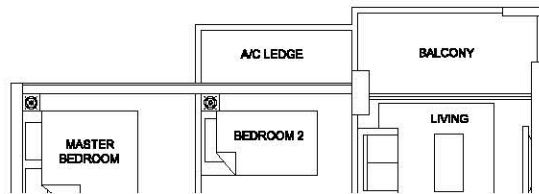

TYPE B2a

69 sqm

#02-33, #05-33, #08-33, #11-33

#02-36, #05-36, #08-36, #11-36 (Mirror Units)

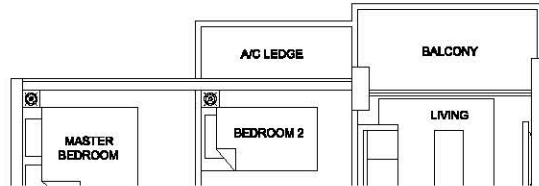

TYPE B2b

69 sqm

#03-33, #06-33, #09-33, #12-33, #14-33, #15-33

#03-36, #06-36, #09-36, #12-36, #14-36 (Mirror Units)

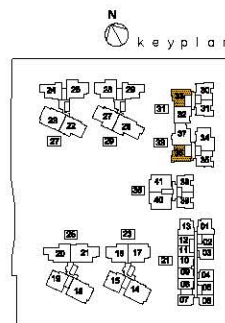

NOTE: #15-33 - HIGH CEILING UNIT

Area includes A/C ledge, balcony, PES, roof terrace and void (where applicable). Orientation and fittings will differ depending on the unit you are purchasing (please refer to key plan). All plans are not to scale and subject to changes as may be required by relevant authorities. All appliances and furniture shown in the plan are for illustration purpose only and not representation of fact. All floor areas are estimated and subjected to final survey.

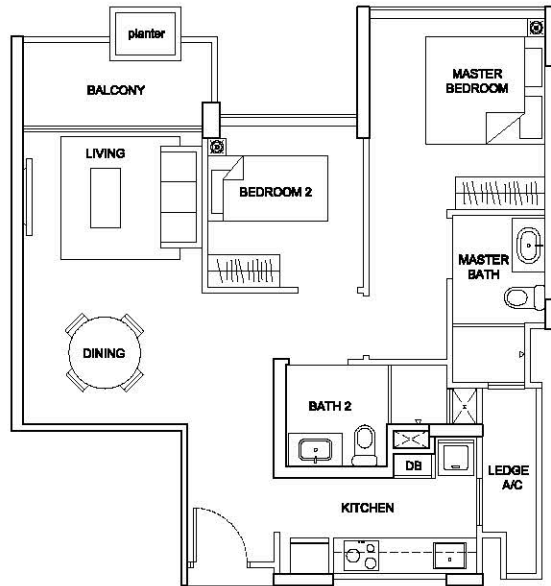

TYPE B3

72 sqm

#04-35, #07-35, #10-35, #13-35

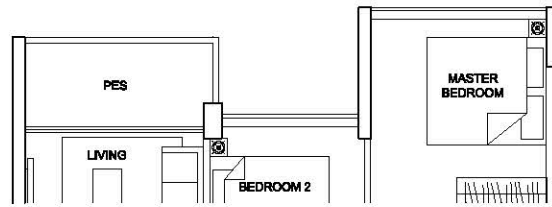

TYPE B3(Pa)

71 sqm

#01-35

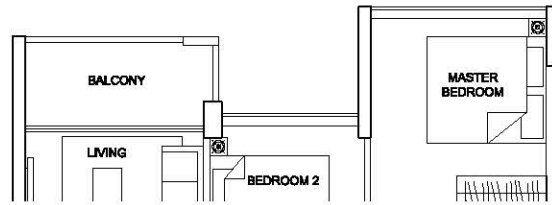

TYPE B3a

71 sqm

#02-35, #05-35, #08-35, #11-35

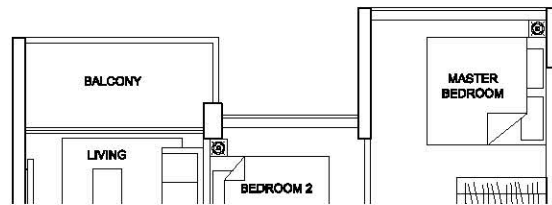

TYPE B3b

71 sqm

#03-35, #06-35, #09-35, #12-35, #14-35



Area includes A/C ledge, balcony, PES, roof terrace and void (where applicable). Orientation and fittings will differ depending on the unit you are purchasing (please refer to key plan). All plans are not to scale and subject to changes as may be required by relevant authorities. All appliances and furniture shown in the plan are for illustration purpose only and not representation of fact. All floor areas are estimated and subjected to final survey.

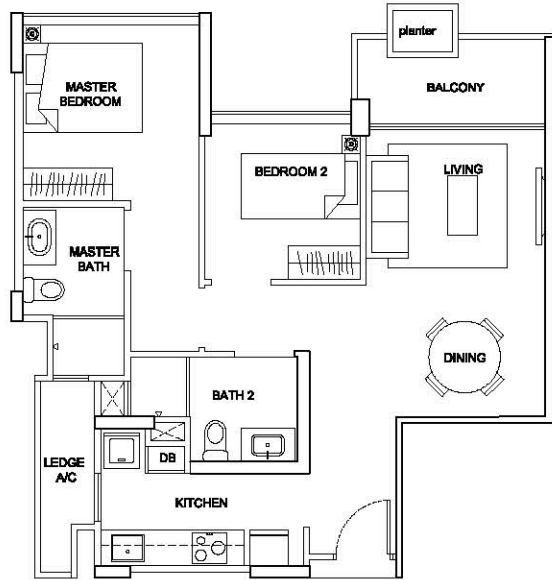

TYPE B4

70 sqm

#02-30, #05-30, #08-30, #11-30, #14-30

#04-38, #07-38, #10-38, #13-38,

#04-31, #07-31, #10-31, #13-31,

#02-39, #05-39, #08-39, #11-39 (Mirror Units)

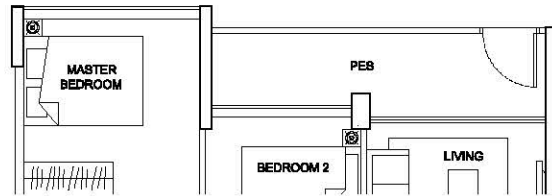

TYPE B4(P)

73 sqm

#01-38

#01-38 (Mirror Unit)



TYPE B4a

70 sqm

#02-38, #03-30, #05-38, #06-30, #08-38, #09-30, #11-38, #12-30

#02-31, #05-31, #08-31, #11-31,

#03-39, #06-39, #09-39, #12-39 (Mirror Units)



TYPE B4b

70 sqm

#04-30, #07-30, #10-30, #13-30,

#03-38, #06-38, #09-38, #12-38, #14-38

#03-31, #06-31, #09-31, #12-31, #14-31, #15-31

#04-39, #07-39, #10-39, #13-39, #14-39 (Mirror Units)

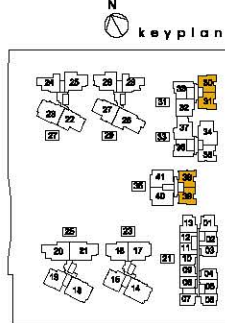

NOTE: #15-31 - HIGH CEILING UNIT

Area includes A/C ledge, balcony, PES, roof terrace and void (where applicable). Orientation and fittings will differ depending on the unit you are purchasing (please refer to key plan). All plans are not to scale and subject to changes as may be required by relevant authorities. All appliances and furniture shown in the plan are for illustration purpose only and not representation of fact. All floor areas are estimated and subjected to final survey.

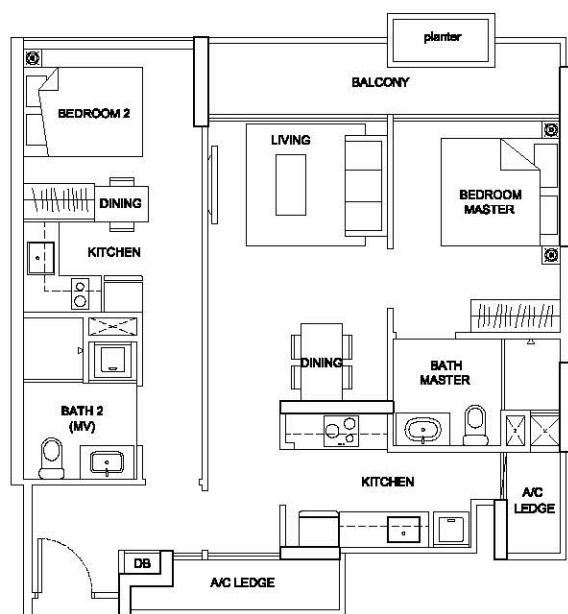

TYPE B5-DK

85 sqm
#04-15, #07-15, #10-15, #13-15,
#04-19, #07-19, #10-19, #13-19
#04-32, #07-32, #10-32, #13-32 (Mirror Units)

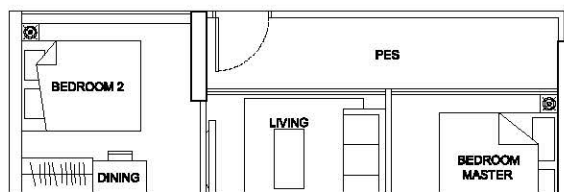

TYPE B5-DK(P)

84 sqm
#01-15
#01-32 (Mirror Unit)

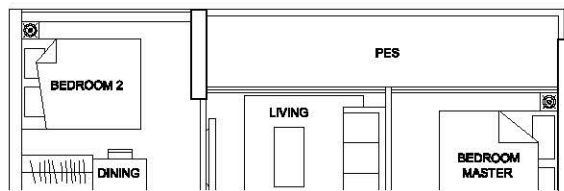

TYPE B5-DK(Pa)

84 sqm
#01-19

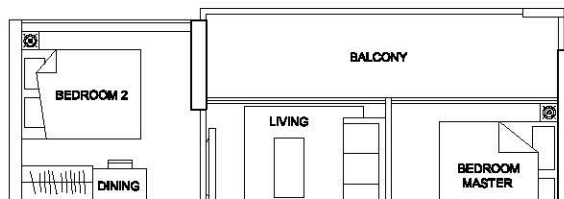

TYPE B5a-DK

85 sqm
#02-15, #05-15, #08-15, #11-15
#02-19, #05-19, #08-19, #11-19
#02-32, #05-32, #08-32, #11-32,
#14-32 (Mirror Units)

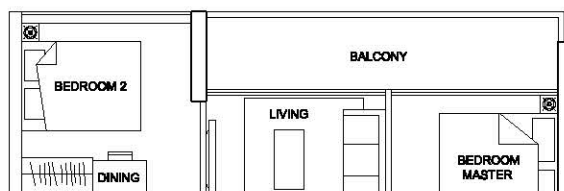

TYPE B5b-DK

84 sqm
#03-15, #06-15, #09-15, #12-15, #14-15, #15-15
#03-19, #06-19, #09-19, #12-19, #14-19, #15-19
#03-32, #06-32, #09-32, #12-32, #15-32 (Mirror Units)

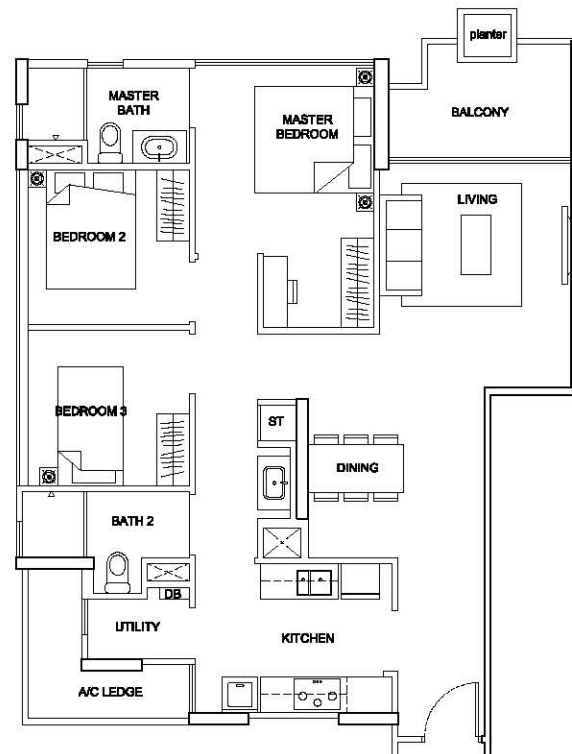
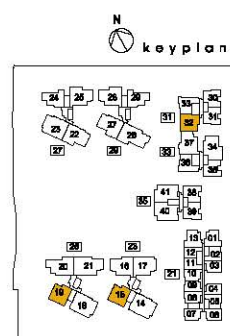

TYPE C2

97 sqm
#04-40, #07-40, #10-40, #13-40
#02-41, #05-41, #08-41, #11-41 (Mirror Units)

Area includes A/C ledge, balcony, PES, roof terrace and void (where applicable). Orientation and fittings will differ depending on the unit you are purchasing (please refer to key plan). All plans are not to scale and subject to changes as may be required by relevant authorities.
All appliances and furniture shown in the plan are for illustration purpose only and not representation of fact.
All floor areas are estimated and subjected to final survey.

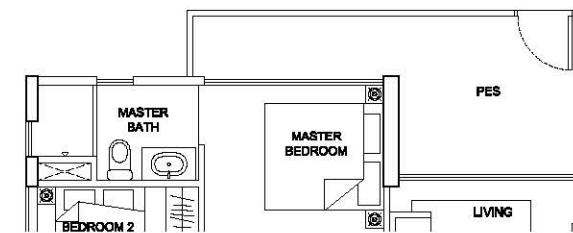

TYPE C2(P)

103 sqm
#01-40
#01-41 (Mirror Unit)



TYPE C2a

103 sqm
#02-40, #05-40, #08-40, #11-40,
#03-41, #06-41, #09-41, #12-41 (Mirror Units)

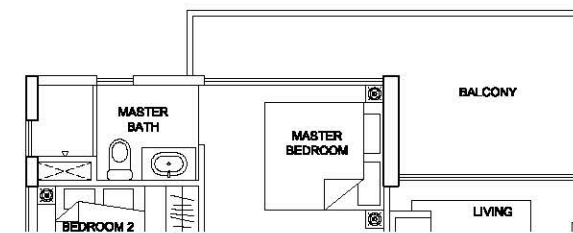

TYPE C2b

103 sqm
#03-40, #06-40, #09-40, #12-40, #14-40
#04-41, #07-41, #10-41, #13-41, #14-41 (Mirror Units)

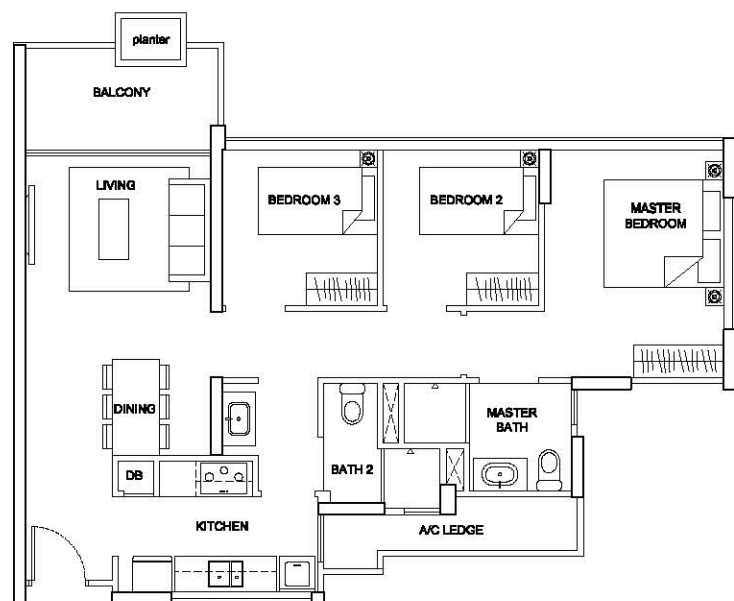
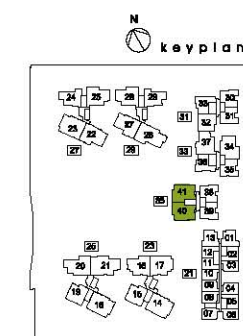

TYPE C1

85 sqm
#04-24, #07-24, #10-24, #13-24 (Mirror Units)
#04-29, #07-29, #10-29, #13-29

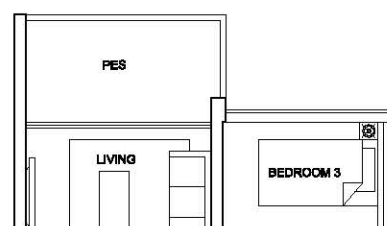

TYPE C1(Pa)

85 sqm
#01-24 (Mirror Unit)
#01-29

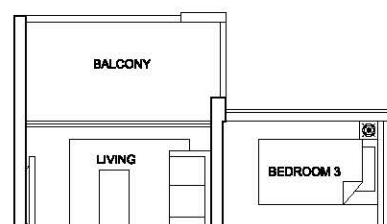

TYPE C1a

85 sqm
#02-24, #05-24, #08-24, #11-24 (Mirror Units)
#02-29, #05-29, #08-29, #11-29

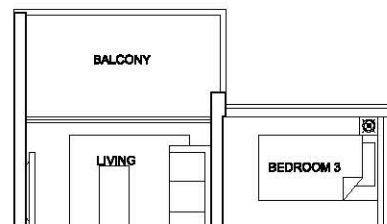

TYPE C1b

85 sqm
#03-24, #06-24, #09-24, #12-24, #14-24 (Mirror Units)
#03-29, #06-29, #09-29, #12-29, #14-29

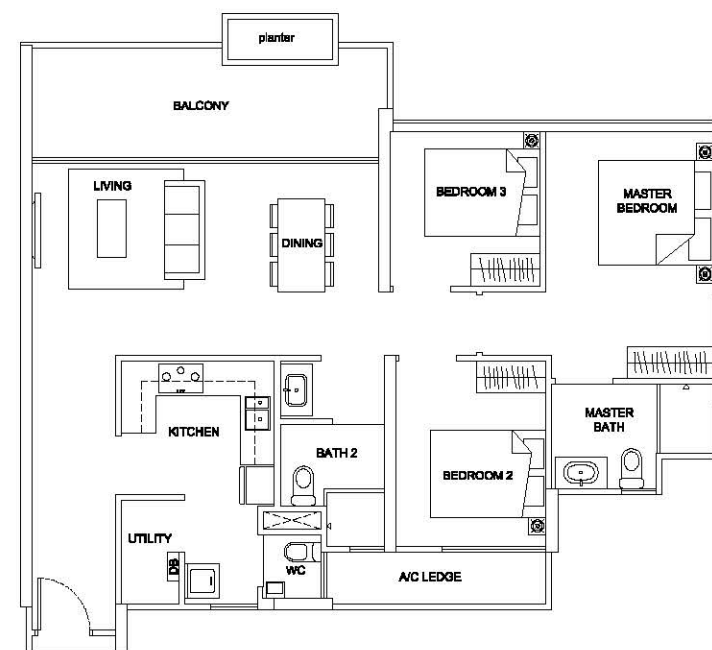

TYPE C3

105 sqm
#02-17, #05-17, #08-17, #11-17
#02-25, #05-25, #08-25, #11-25,
#03-37, #06-37, #09-37, #12-37
#04-16, #07-16, #10-16, #13-16
#02-28, #05-28, #08-28, #11-28 (Mirror Units)

Area includes A/C ledge, balcony, PES, roof terrace and void (where applicable). Orientation and fittings will differ depending on the unit you are purchasing (please refer to key plan). All plans are not to scale and subject to changes as may be required by relevant authorities.
All appliances and furniture shown in the plan are for illustration purpose only and not representation of fact.
All floor areas are estimated and subjected to final survey.

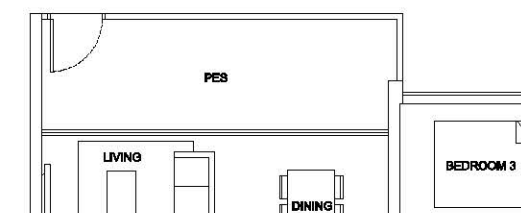

TYPE C3(P)

104 sqm
#01-16 (Mirror Unit)
#01-17, #01-37

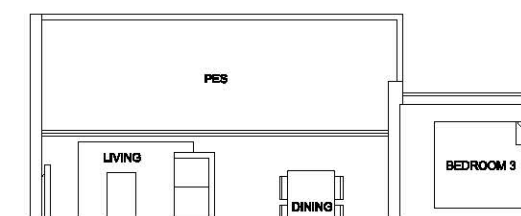

TYPE C3(Pa)

104 sqm
#01-25
#01-28 (Mirror Unit)

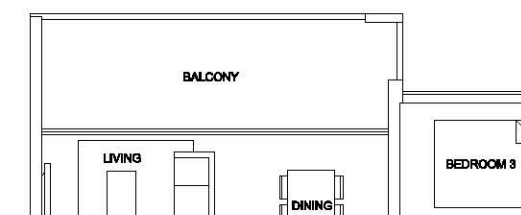

TYPE C3a

104 sqm
#03-25, #06-25, #09-25, #12-25
#02-18, #05-18, #08-18, #11-18
#03-28, #06-28, #09-28, #12-28 (Mirror Units)

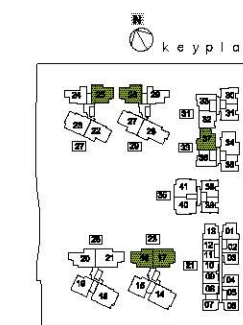

Area includes A/C ledge, balcony, PES, roof terrace and void (where applicable). Orientation and fittings will differ depending on the unit you are purchasing (please refer to key plan). All plans are not to scale and subject to changes as may be required by relevant authorities.
All appliances and furniture shown in the plan are for illustration purpose only and not representation of fact.
All floor areas are estimated and subjected to final survey.

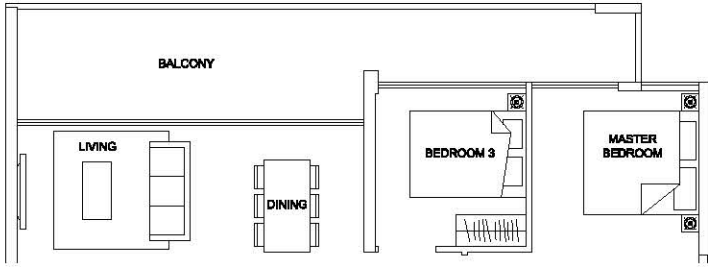

TYPE C3b

110 sqm

#03-17, #08-17, #09-17, #12-17
#04-37, #07-37, #10-37, #13-37

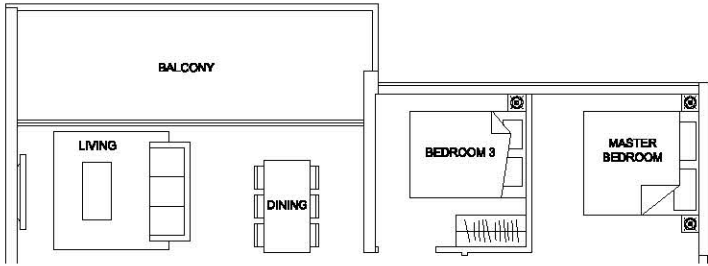

TYPE C3c

104 sqm

#04-17, #07-17, #10-17, #13-17, #14-17,
#04-25, #07-25, #10-25, #13-25, #14-25,
#02-37, #05-37, #08-37, #11-37, #14-37

#03-16, #06-16, #09-16, #12-16, #14-16,
#04-26, #07-26, #10-26, #13-26, #14-26 (Mirror Units)

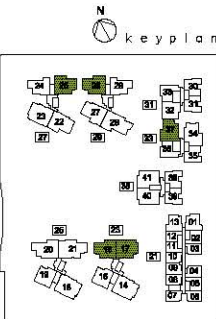

Area includes A/C ledge, balcony, PES, roof terrace and void (where applicable). Orientation and facings will differ depending on the unit you are purchasing (please refer to key plan). All plans are not to scale and subject to changes as may be required by relevant authorities.
All appliances and furniture shown in the plan are for illustration purpose only and not representation of fact.
All floor areas are estimated and subjected to final survey.

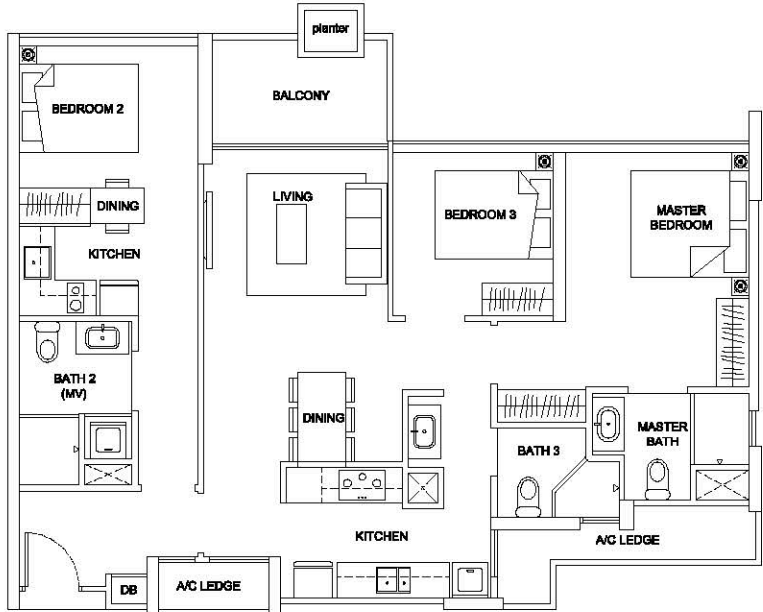

TYPE C5-DK

107 sqm

#04-27, #07-27, #10-27, #13-27

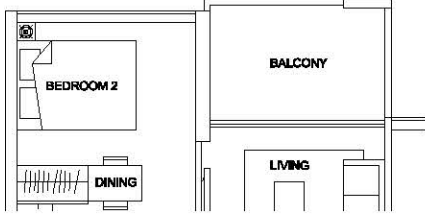

TYPE C5a-DK

107 sqm

#02-27, #05-27, #08-27, #11-27

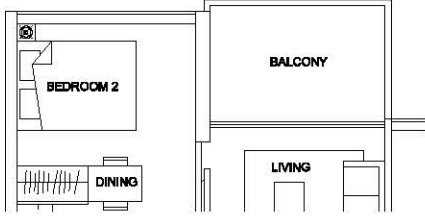

TYPE C5c-DK

107 sqm

#03-27, #06-27, #09-27, #12-27, #14-27

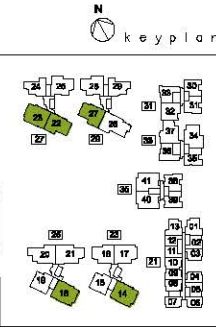

Area includes A/C ledge, balcony, PES, roof terrace and void (where applicable). Orientation and facings will differ depending on the unit you are purchasing (please refer to key plan). All plans are not to scale and subject to changes as may be required by relevant authorities.
All appliances and furniture shown in the plan are for illustration purpose only and not representation of fact.
All floor areas are estimated and subjected to final survey.

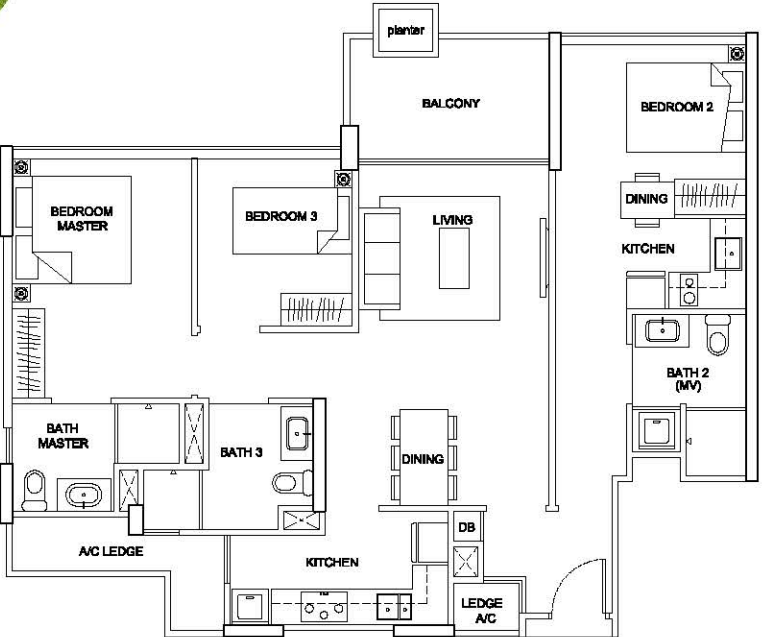

TYPE C4-DK

105 sqm

#02-34, #05-34, #08-34, #11-34,
#14-34

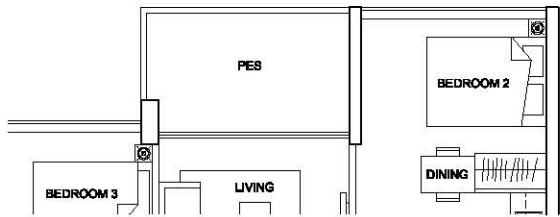

TYPE C4-DK(Pa)

105 sqm

#01-34

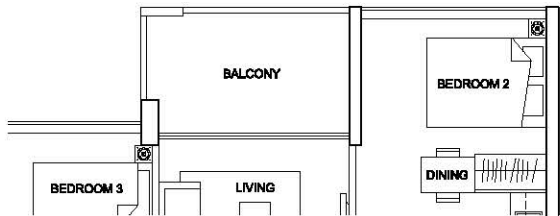

TYPE C4a-DK

105 sqm

#03-34, #06-34, #09-34, #12-34

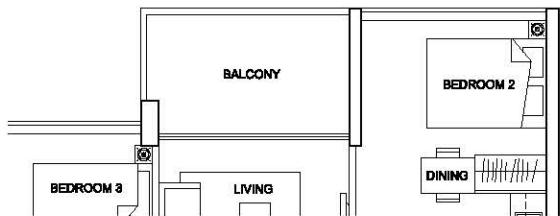

TYPE C4b-DK

105 sqm

#04-34, #07-34, #10-34, #13-34,
#15-34

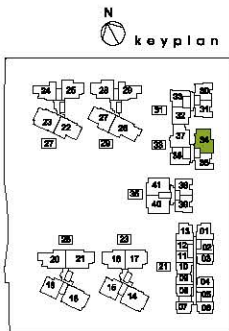

NOTE: #15-34 - HIGH CEILING UNIT
Area includes A/C ledge, balcony, PES, roof terrace and void (where applicable). Orientation and facings will differ depending on the unit you are purchasing (please refer to key plan). All plans are not to scale and subject to changes as may be required by relevant authorities.
All appliances and furniture shown in the plan are for illustration purpose only and not representation of fact.
All floor areas are estimated and subjected to final survey.

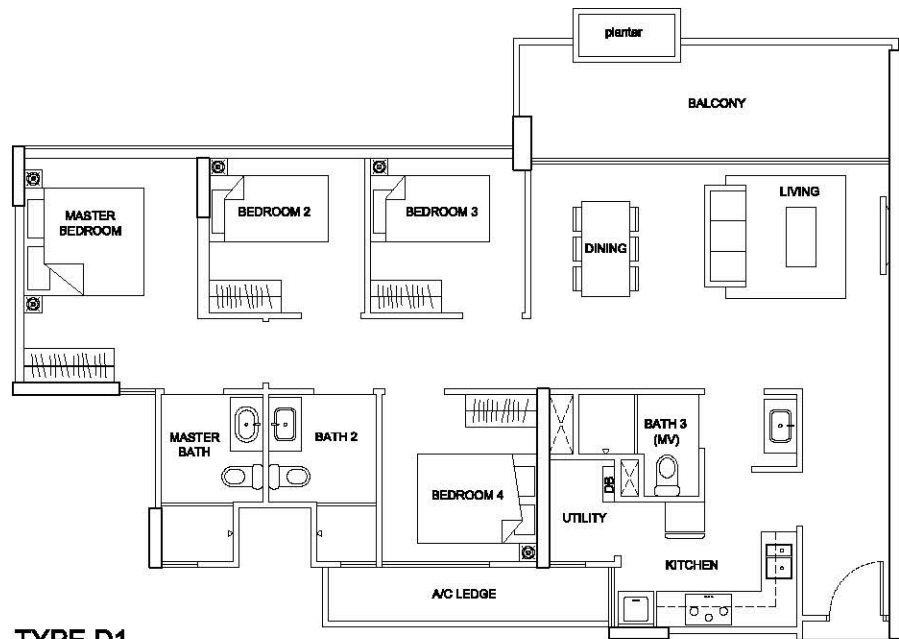

TYPE D1

117 sqm

#02-20, #05-20, #08-20, #11-20,
#14-20

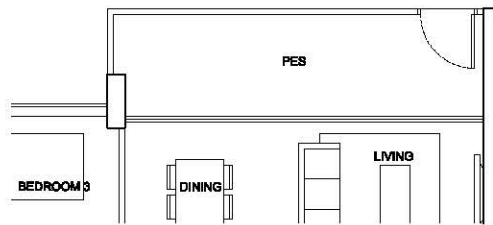

TYPE D1(P)

115 sqm

#01-20

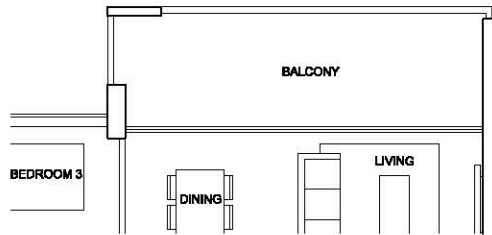

TYPE D1a

116 sqm

#03-20, #06-20, #09-20, #12-20

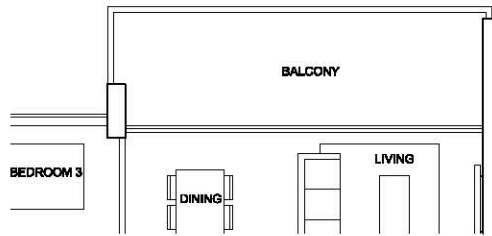

TYPE D1b

116 sqm

#04-20, #07-20, #10-20, #13-20

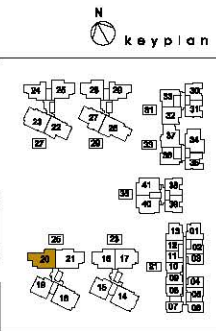

Area includes A/C ledge, balcony, PES, roof terrace and void (where applicable). Orientation and facings will differ depending on the unit you are purchasing (please refer to key plan). All plans are not to scale and subject to changes as may be required by relevant authorities.
All appliances and furniture shown in the plan are for illustration purpose only and not representation of fact.
All floor areas are estimated and subjected to final survey.

4 BR
DUAL KEY
SUITE

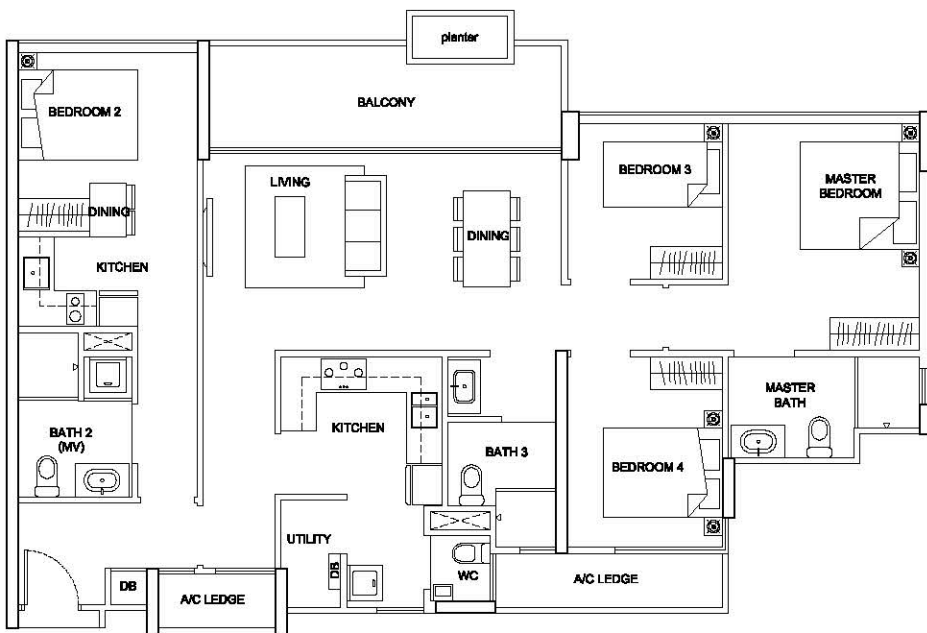

TYPE D2-DK
132 sqm
#04-21, #07-21, #10-21, #13-21

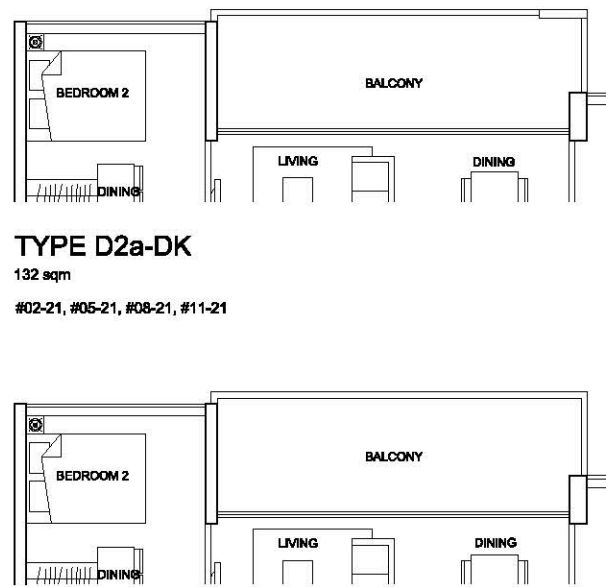

TYPE D2a-DK
132 sqm
#02-21, #05-21, #08-21, #11-21

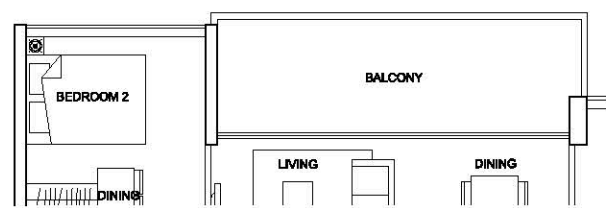

TYPE D2b-DK
132 sqm
#03-21, #06-21, #09-21, #12-21, #14-21

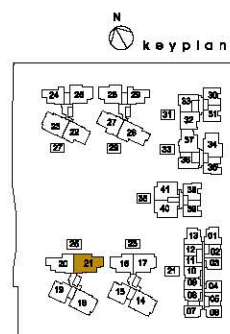

Area includes A/C ledge, balcony, PES, roof terrace and void (where applicable). Orientation and fittings will differ depending on the unit you are purchasing (please refer to key plan). All plans are not to scale and subject to changes as may be required by relevant authorities. All appliances and furniture shown in the plan are for illustration purpose only and not representation of fact. All floor areas are estimated and subjected to final survey.

4 BR
SUITE

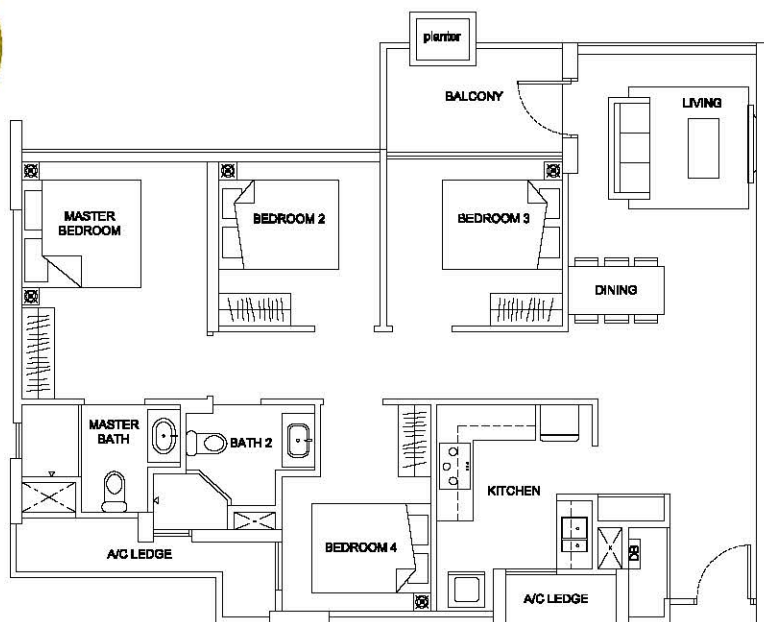

TYPE D3
107 sqm
#02-14, #05-14, #08-14, #11-14, #14-14,
#02-18, #05-18, #08-18, #11-18, #14-18,
#04-22, #07-22, #10-22, #13-22,
#02-23, #05-23, #08-23, #11-23 (Mirror Units)

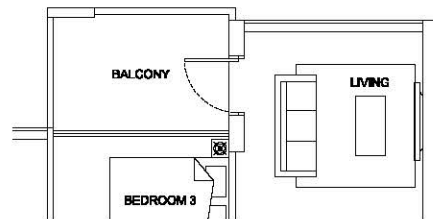

TYPE D3a
107 sqm
#02-22, #05-22, #08-22, #11-22,

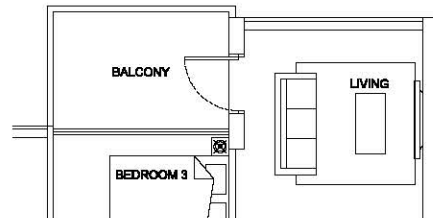

TYPE D3b
117 sqm
#03-14, #06-14, #09-14, #12-14,
#03-18, #06-18, #09-18, #12-18,
#03-23, #06-23, #09-23, #12-23 (Mirror Units)

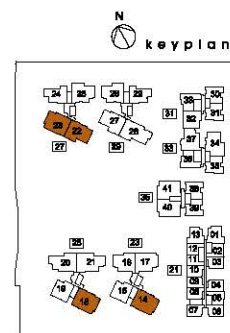

Area includes A/C ledge, balcony, PES, roof terrace and void (where applicable). Orientation and fittings will differ depending on the unit you are purchasing (please refer to key plan). All plans are not to scale and subject to changes as may be required by relevant authorities. All appliances and furniture shown in the plan are for illustration purpose only and not representation of fact. All floor areas are estimated and subjected to final survey.

5 BR
SUITE

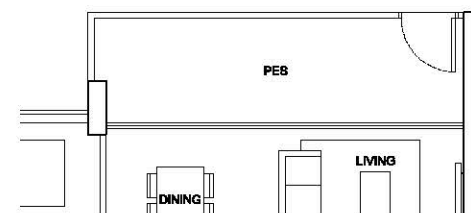

TYPE E1(P)
127 sqm
#01-26

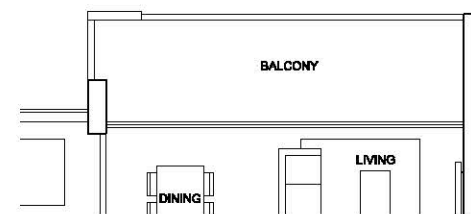

TYPE E1a
127 sqm
#03-26, #06-26, #09-26, #12-26

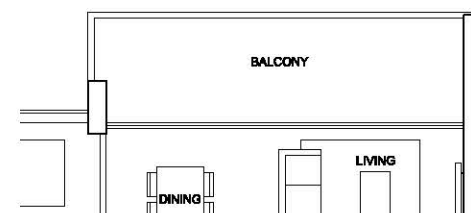

TYPE E1b
127 sqm
#04-26, #07-26, #10-26, #13-26,
#14-26

Area includes A/C ledge, balcony, PES, roof terrace and void (where applicable). Orientation and fittings will differ depending on the unit you are purchasing (please refer to key plan). All plans are not to scale and subject to changes as may be required by relevant authorities. All appliances and furniture shown in the plan are for illustration purpose only and not representation of fact. All floor areas are estimated and subjected to final survey.

3 BR
GARDEN
DUPLEX

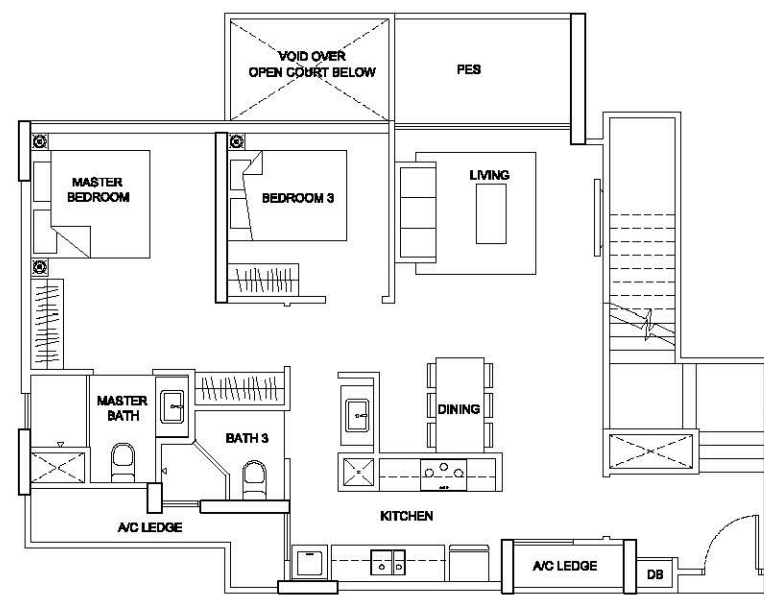

TYPE GD1-DK UPPER
TYPE GD1-DK
166 sqm
#01-14, #01-18, #01-22,
#01-23, #01-27 (Mirror Units)

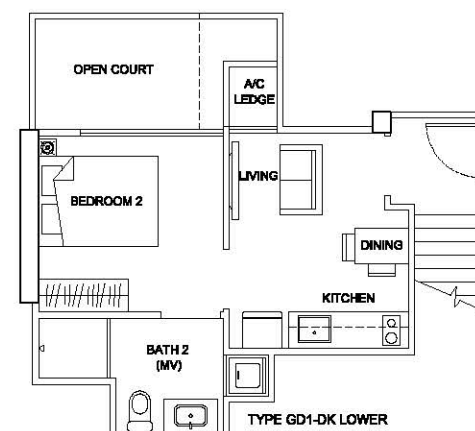

PRIVATE CAR PARK LOTS
(located at B1, location varies
depending on actual unit)

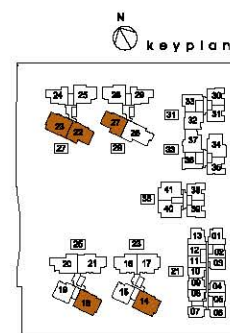

Area includes A/C ledge, balcony, PES, roof terrace and void (where applicable). Orientation and fittings will differ depending on the unit you are purchasing (please refer to key plan). All plans are not to scale and subject to changes as may be required by relevant authorities. All appliances and furniture shown in the plan are for illustration purpose only and not representation of fact. All floor areas are estimated and subjected to final survey.

4 BR
GARDEN
DUPLEX

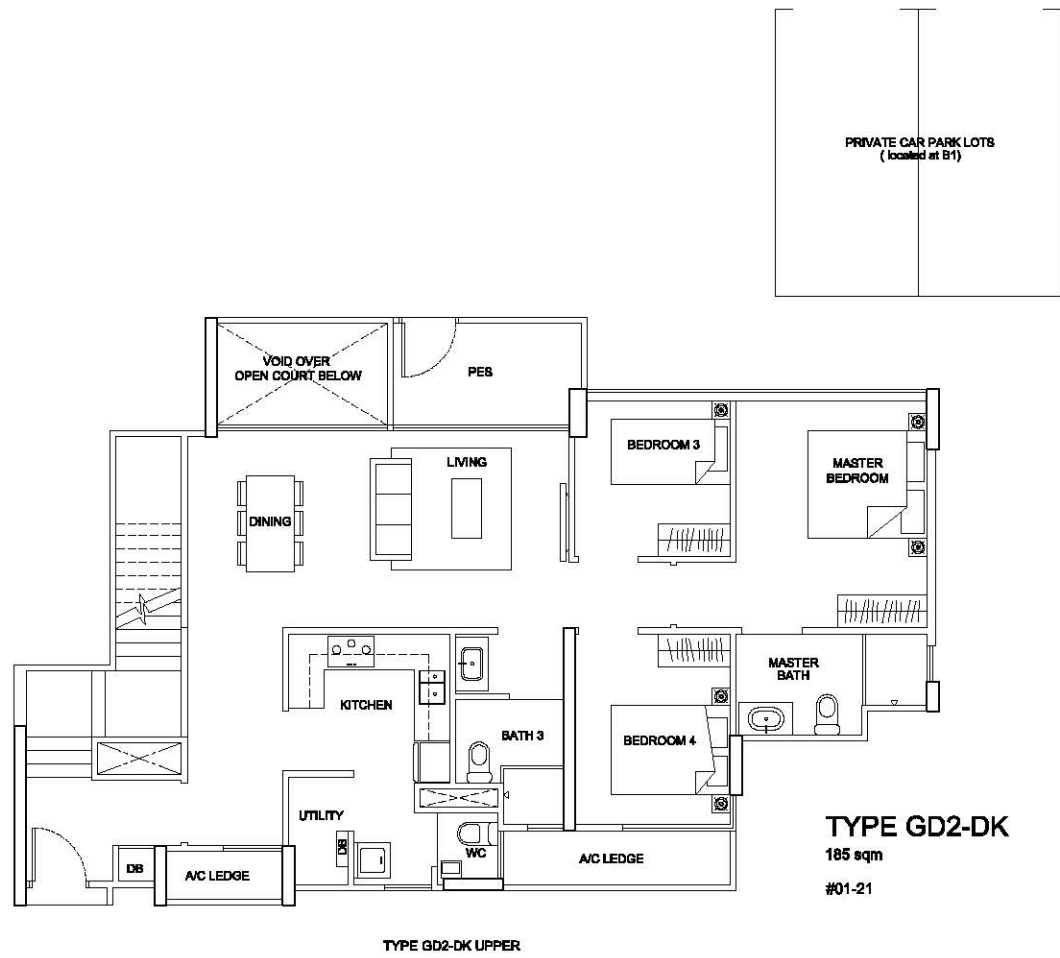

Area includes A/C ledge, balcony, PES, roof terrace and void (where applicable). Orientation and facade will differ depending on the unit you are purchasing (please refer to key plan). All plans are not to scale and subject to changes as may be required by relevant authorities.
All appliances and furniture shown in the plan are for illustration purpose only and not representation of fact.
All floor areas are estimated and subjected to final survey.

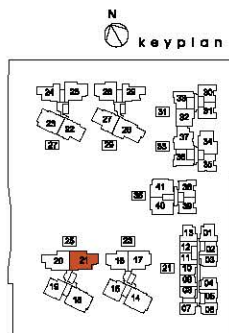
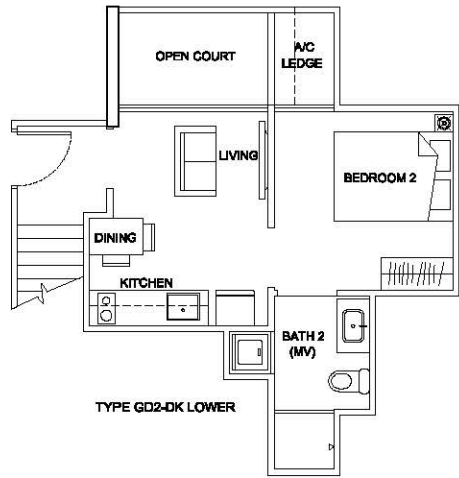

PENTHOUSE

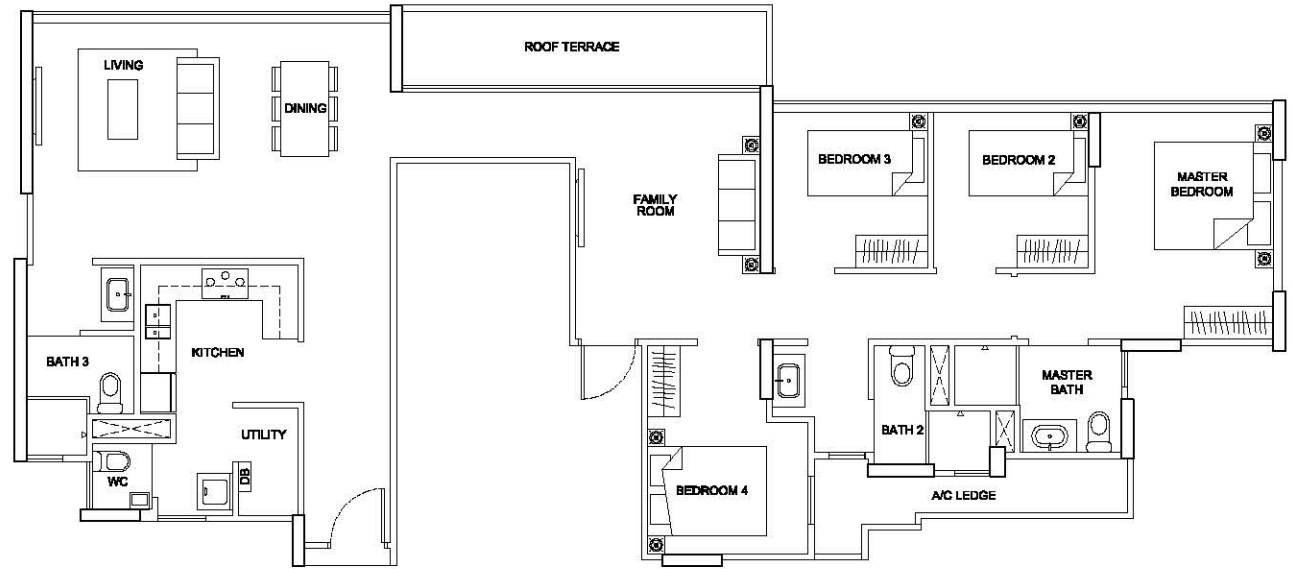

NOTE: HIGH CEILING FOR ALL PENTHOUSE UNITS

Area includes A/C ledge, balcony, PES, roof terrace and void (where applicable). Orientation and facade will differ depending on the unit you are purchasing (please refer to key plan). All plans are not to scale and subject to changes as may be required by relevant authorities.
All appliances and furniture shown in the plan are for illustration purpose only and not representation of fact.
All floor areas are estimated and subjected to final survey.

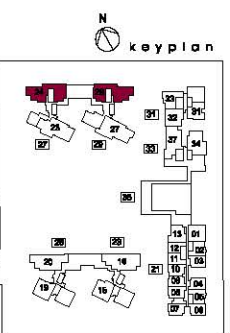

PENTHOUSE

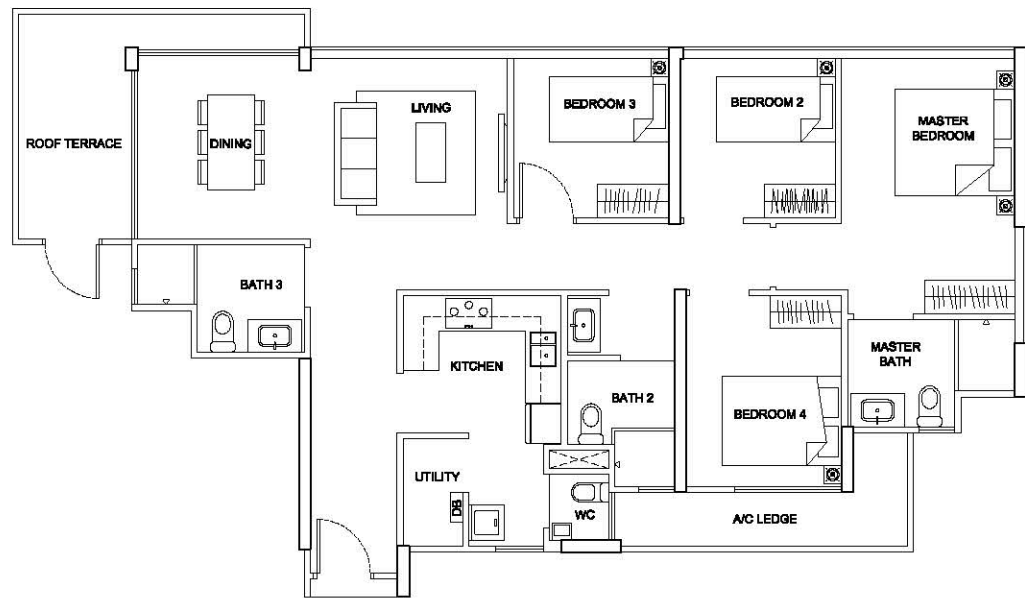

NOTE: HIGH CEILING FOR ALL PENTHOUSE UNITS

Area includes A/C ledge, balcony, PES, roof terrace and void (where applicable). Orientation and facade will differ depending on the unit you are purchasing (please refer to key plan). All plans are not to scale and subject to changes as may be required by relevant authorities.
All appliances and furniture shown in the plan are for illustration purpose only and not representation of fact.
All floor areas are estimated and subjected to final survey.

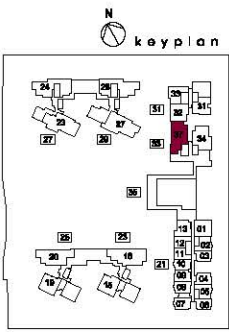

PENTHOUSE

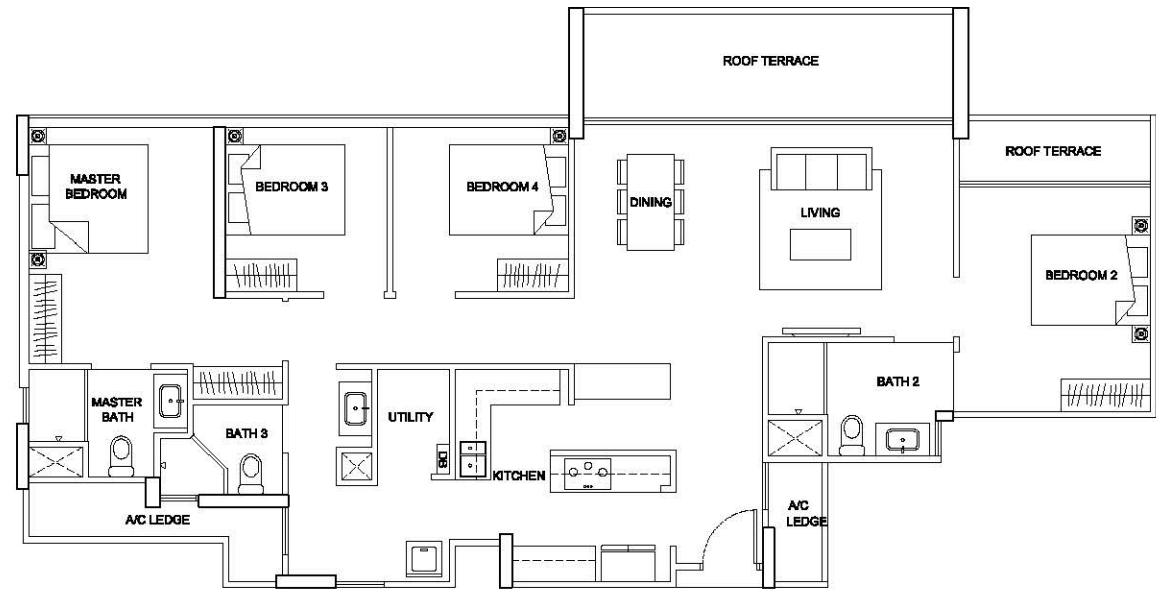

NOTE: HIGH CEILING FOR ALL PENTHOUSE UNITS

Area includes A/C ledge, balcony, PES, roof terrace and void (where applicable). Orientation and facade will differ depending on the unit you are purchasing (please refer to key plan). All plans are not to scale and subject to changes as may be required by relevant authorities.
All appliances and furniture shown in the plan are for illustration purpose only and not representation of fact.
All floor areas are estimated and subjected to final survey.

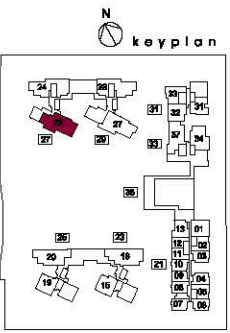



TYPE PH4
146 sqm
#15-27

NOTE: HIGH CEILING FOR ALL PENTHOUSE UNITS
Area includes A/C ledge, balcony, PES, roof terrace and void (where applicable). Orientation and setbacks will differ depending on the unit you are purchasing (please refer to key plan). All plans are not to scale and subject to changes as may be required by relevant authorities.
All appliances and furniture shown in the plan are for illustration purpose only and not representation of fact.
All floor areas are estimated and subjected to final survey.

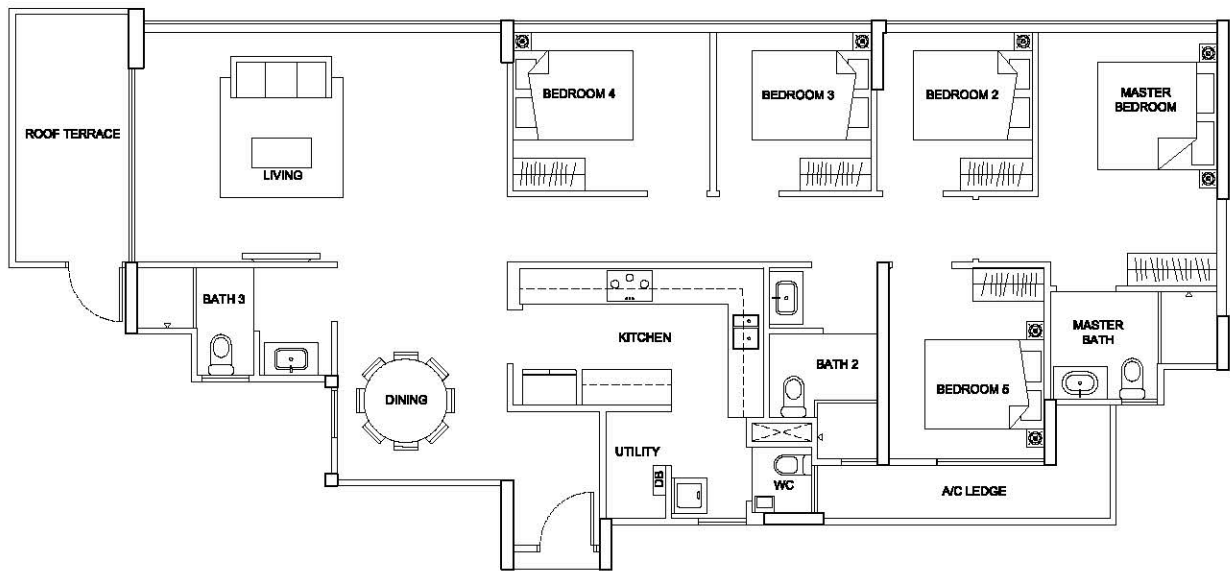
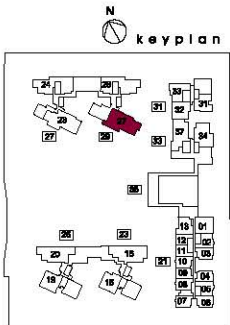

TYPE PH6
149 sqm
#15-16

NOTE: HIGH CEILING FOR ALL PENTHOUSE UNITS
Area includes A/C ledge, balcony, PES, roof terrace and void (where applicable). Orientation and setbacks will differ depending on the unit you are purchasing (please refer to key plan). All plans are not to scale and subject to changes as may be required by relevant authorities.
All appliances and furniture shown in the plan are for illustration purpose only and not representation of fact.
All floor areas are estimated and subjected to final survey.

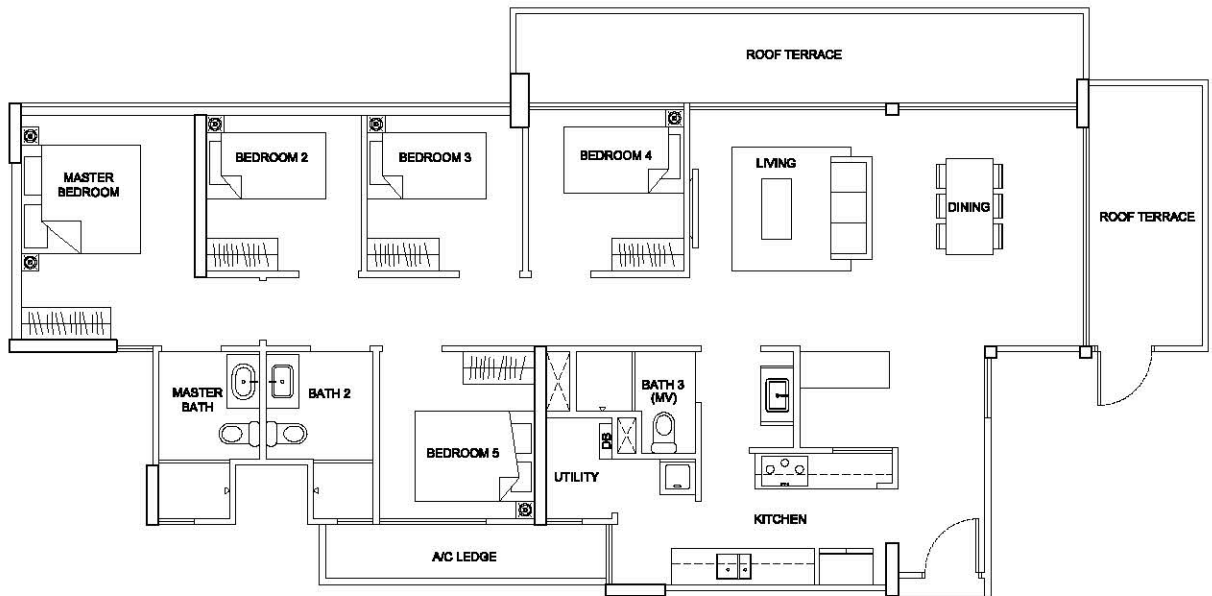
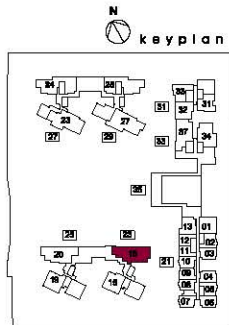

TYPE PH5
149 sqm
#15-20

NOTE: HIGH CEILING FOR ALL PENTHOUSE UNITS
Area includes A/C ledge, balcony, PES, roof terrace and void (where applicable). Orientation and setbacks will differ depending on the unit you are purchasing (please refer to key plan). All plans are not to scale and subject to changes as may be required by relevant authorities.
All appliances and furniture shown in the plan are for illustration purpose only and not representation of fact.
All floor areas are estimated and subjected to final survey.

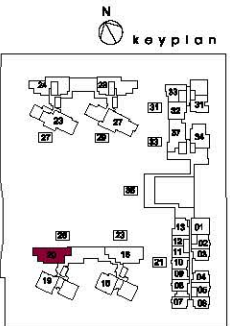



MCC LAND (SINGAPORE) PTE LTD
中冶置业(新加坡)有限公司

www.thesantorini.sg
6684 6868 / 9835 0001

Developer: MCC Land (Singapore) Pte Ltd (RCB: 201004190D) • Developer's License No: C1117 dated 23 Jan 2014 • Tenure of Land: 99 years from 16 Oct 2013 • Mukim/Lot No: Lot 7271C of Mukim 28, Singapore • Building Plan No: A1098-00391-2013-BP01 dated 16 Feb 2014 • Planning Approval No: P250713-0302-2000 dated 22 Jan 2014 • Project Account No: Malayan Banking Berhad for Project Account Number 04011510006 for MCC Land (Singapore) Pte Ltd • Expected Date of Vacant Possession: 18 July 2018 • Expected Date of Legal Completion: 18 July 2021 • T&C apply